

Operating instructions HG63 and HG63-P Moisture Analyzers

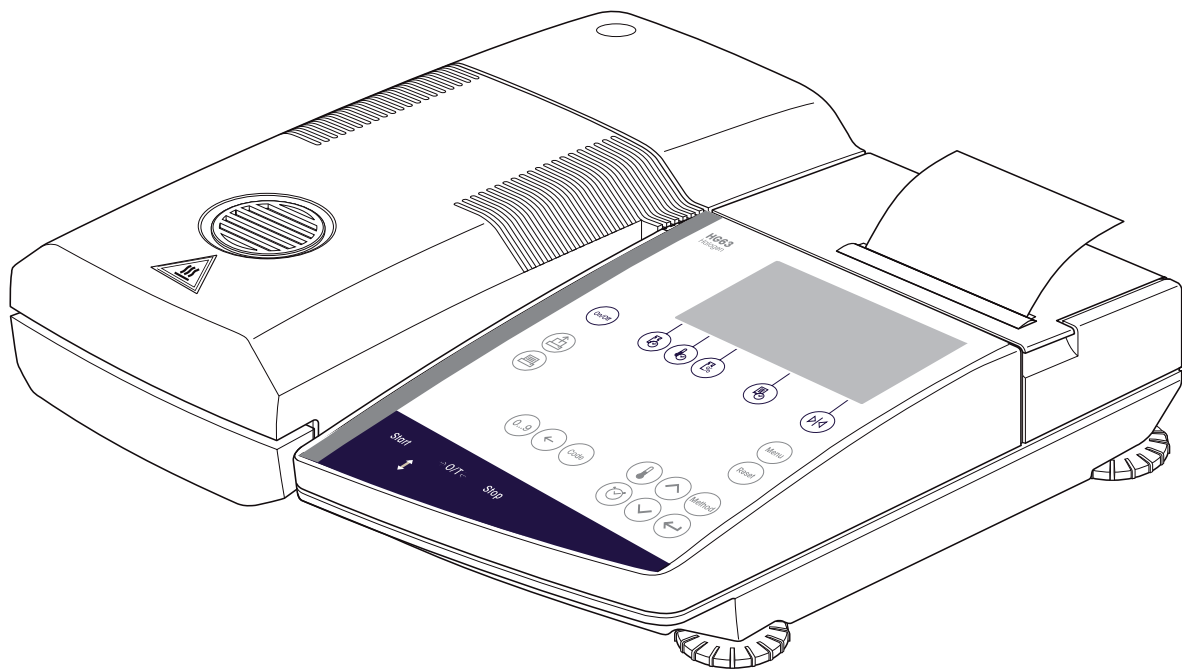

Overview of your HG63 Halogen Moisture Analyzer

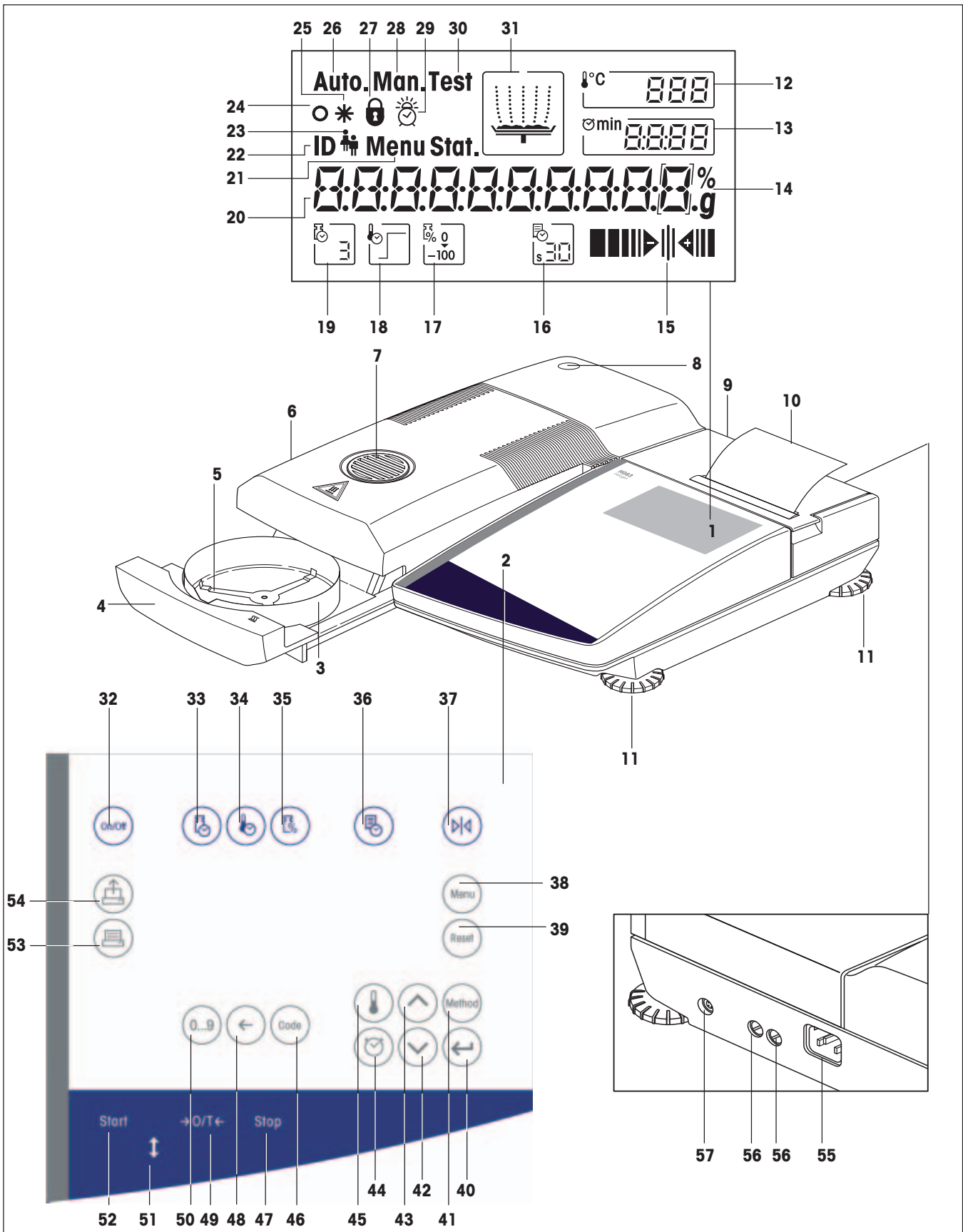

Display, controls and connections of your HG63

No.	Designation	Info see Section	No.	Designation	Info see Section
1	Display	all	29	Symbol for audio signal device (beeper)	6.12
2	Keypad	all	30	Symbol for test measurement	4.11
3	Draft shield	2.3	31	Status display (User guide)	2.6
4	Automatic sample chamber	2.6	32	Key «On/Off»	2.6
5	Sample pan holder	2.3	33	Function key «Switch-off criterion»	4.4
6	Heating module	7.6	34	Function key «Drying program»	4.2
7	Inspection window and vent	6.4	35	Function key «Display mode»	4.5
8	Level indicator (level)	2.3	36	Function key «Print interval»	4.6
9	Printer cover	7.2	37	Key «Target weight» (weighing-in aid)	4.7
10	Built-in printer (option)	7.5	38	Key «Menu»	6
11	Leveling screw	2.3	39	Key «Reset»	2.6
12	Display of drying temperature	4.3	40	Key «Accept entry»	all
13	Display of drying time / Method number (Selection)	4.4	41	Key «Method» (method selection)	5.2
14	Display of unit (percent or grams)	4.5	42	Key «Scroll down»	2.5
15	Weighing-in aid	4.7	43	Key «Scroll up»	2.5
16	Function display "Print interval"	4.6	44	Key «Drying time»	4.4
17	Function display "Display mode"	4.5	45	Key «Drying temperature»	4.3
18	Function display "Drying program"	4.2	46	Key «Code» (record comment)	4.8
19	Function display "Switch-off criterion"	4.4	47	Key «Stop» (stop drying)	4.9/4.10
20	Dialog display (measured values, menu dialog, text entry, etc.)	all	48	Key «Delete»	4.1
21	Menu symbol	6	49	Key «Tare» (zero)	2.6
22	Method symbol	5	50	Key «0...9» (alphanumeric entry)	4.8
23	Symbol for record comment	4.9	51	Key «Open/close auto sample chamber»	2.6
24	Stability detector	8.2/8.3	52	Key «Start» (start of drying)	2.6
25	Symbol for calculated result	2.6/4.10	53	Key «Print»	4.10/6.1
26	Symbol for automatic operating mode of the automatic sample chamber	6.11	54	Key «Paper feed»	2.4/7.2
27	Symbol for Key protection	6.13	55	Power supply receptacle	2.3
28	Symbol for manual operating mode of the automatic sample chamber	6.11	56	Power line fuses	7.3
			57	LocalCAN universal interface ports	9.2

Contents

1	Getting to know your Moisture Analyzer	6
1.1	Introduction	6
1.2	What is the Halogen Moisture Analyzer used for?	6
1.3	Safety has priority	7
1.4	Disposal	9
1.5	Important information for these instructions	10
2	Your first measurement in next to no time	11
2.1	Unpacking and checking the standard equipment	11
2.2	Selecting the location	12
2.3	Setting up, leveling and connecting to power supply	12
2.4	Preparing the printer	15
2.5	Setting the date and time	16
2.6	Your first measurement	18
3	How to obtain the best results	22
3.1	Measurement principle of the Halogen Moisture Analyzer	22
3.2	Notes on adjustment of the balance and the heating module	23
3.3	Optimum sample preparation	24
3.4	Further information on moisture determination	24
4	Practical application of your Moisture Analyzer	25
4.1	Operating principles	25
4.2	Selecting the drying program	26
4.3	Setting the drying temperature	26
4.4	Selecting the switch-off criterion	28
4.5	Selecting the display mode	30
4.6	Defining the print interval	32
4.7	Working with the weighing-in aid	33
4.8	Comment line	35
4.9	Information on the measurement record	37
4.10	Performing a measurement	38
4.11	Test measurement	42
5	Methods facilitate your work	43
5.1	What is a method?	43
5.2	Recalling a method	44
5.3	Changing methods	44
5.4	Method menu	46
5.4.1	Freely selectable switch-off criterion	46
5.4.2	Free factor (-MC)	47
5.4.3	Free factor (g)	48
5.4.4	Drying temperature to 200 °C without time limitation	48
5.5	Printing out methods parameters	49

6	The menu (basic settings of the instrument)	50
6.1	Menu operation	50
6.2	Adjusting the balance	51
6.3	Testing the balance	52
6.4	Adjusting the heating module	53
6.5	Testing the heating module	55
6.6	Resetting to the factory settings	57
6.7	Clearing the method memory	57
6.8	Setting the time	58
6.9	Entering the date	58
6.10	Setting the vibration adapter	58
6.11	Selecting operating mode of the automatic sample chamber	59
6.12	Audio signal	59
6.13	Protecting your settings against change	60
6.14	Superimposing or removing the function symbols	60
6.15	Switching the printer on or off	61
6.16	Switching the method option on or off	61
6.17	Selecting the dialog language	62
6.18	Menu overview HG63	63
7	Servicing and replacing individual parts	64
7.1	Cleaning	64
7.2	Changing the printer paper and ribbon	65
7.3	Replacing the power line fuses	66
7.4	Printer test	67
7.5	Installing the built-in printer	67
7.6	Dismantling and replacing the heating module	67
8	If problems arise on occasion	69
8.1	Notes on the error messages	69
8.2	Meaning of the error messages	70
8.3	What if...?	72
9	Further useful information	75
9.1	Notes on interpretation of the measurement results and the ideal sample weight	75
9.2	LocalCAN universal interface	75
9.3	Application brochure	76
9.4	Switch-off criterion "Weight loss per unit of time"	76
9.5	Comments on certified version	77
9.6	Technical data	78
9.7	MT-SICS Interface commands and functions	81
9.8	Optional equipment, expendable material and spare parts	83
10	Index	84

1 Getting to know your Moisture Analyzer

Please read through this Section carefully, it contains important information for safe and economical operation of your Moisture Analyzer.

1.1 Introduction

Thank you for deciding to purchase a Halogen Moisture Analyzer from METTLER TOLEDO – you have made a wise choice. Your Moisture Analyzer is fast and reliable. It offers a high level of operating convenience and useful functions to facilitate determination of the moisture content of your samples.

Behind your instrument stands METTLER TOLEDO, a leading manufacturer of not only balances and scales for the lab and production, but also analytical measuring instruments. A customer service network covering the entire globe with well trained personnel is at your service at all times, whether you are choosing accessories or require guidance for a specific application to ensure optimum utilization of your instrument.

To ensure you make full use of the possibilities offered by your Moisture Analyzer, we advise you to read through these operating instructions very carefully.

1.2 What is the Halogen Moisture Analyzer used for?

Your Halogen Moisture Analyzer is used for determining the moisture content of almost any substance. The instrument works on the thermogravimetric principle: At the start of the measurement the Moisture Analyzer determines the weight of the sample, the sample is then quickly heated by the integral halogen heating module and the moisture vaporizes. During the drying process the instrument continually measures the weight of the sample and displays the reduction in moisture. Once drying has been completed, the moisture or solids content of your sample is displayed as the final result.

Of decisive importance in practice is the rate of heating. In comparison with conventional infrared heating or the drying oven method, for example, the halogen heating module of your instrument needs a shorter time to reach its maximum heating power. It also allows use of high temperatures, an additional factor in shortening the drying time. Uniform heating of the sample material ensures good repeatability of the drying results and makes it possible to use a smaller amount of sample.

All parameters of a measurement (drying temperature, drying time, etc.) can be preselected. But your Moisture Analyzer offers many other possibilities. To avoid exceeding the scope of this introduction, only a few of these are listed here:

- 10 different methods can be individually optimized to suit your samples, and easily activated at a keystroke.
- You can choose between various types of result display at any time.
- Your settings and measurement results can be recorded, stored and protected.
- One comment line can be entered for each measurement.
- Thanks to the built-in rechargeable battery your valuable data remain stored even on power failure.

This wealth of functions notwithstanding, your Moisture Analyzer is very simple to operate. The status display (User guide) guides you step by step through the measurement cycle. You always know which particular stage in a measurement is currently being executed by the instrument and the next operating step. To exclude faulty handling in routine work, the keypad can be locked to prevent access to all but the elementary functions. The motorized, automatic sample chamber offers the operating convenience you are familiar with from compact disk (CD) players. Moreover, the motorized sample chamber opens up new possibilities for automatic operation of the instrument (loading by means of robots) when used with the LocalCAN universal interface installed as standard.

Besides operating convenience, however, the quality of the measurement results is still what counts above all. The built-in weighing cell meets the high standard which has made METTLER TOLEDO the worldwide market leader in the field of high-resolution precision balances.

A brief word regarding standards, directives and procedures for quality assurance. The Moisture Analyzer conforms with all common standards and directives. It supports stipulations, work techniques and result records as demanded by all international quality assurance systems, e.g. **GLP (Good Laboratory Practice)**, **GMP (Good Manufacturing Practice)**. The instrument has a EC declaration of conformity and METTLER TOLEDO as the manufacturer has been awarded ISO 9001 and ISO 14001 certification. This provides you with the assurance that your capital investment is protected in the long term by a high product quality and a comprehensive service package (repairs, maintenance, servicing, calibration service).

You will find further information in the following Sections of these operating instructions. Please read through this information carefully to ensure you can use your instrument in an optimum and safe manner.

1.3 Safety has priority



Your Moisture Analyzer employs state of the art technology and meets the latest demands regarding instrument safety. This notwithstanding, improper operation can endanger personnel and cause damage to tangibles. For safe and dependable operation, please comply with the following instructions:

- The Moisture Analyzer is used for determining the moisture in samples. Please use the instrument exclusively for this purpose. Any other type of use can endanger personnel and damage the instrument or other tangibles.
- The Moisture Analyzer must not be operated in a hazardous environment and only under the ambient conditions specified in these instructions.
- The Moisture Analyzer may be operated only by trained personnel who are familiar with the properties of the samples used and with the handling of the instrument.
- Your Moisture Analyzer is supplied with a 3-pin power cable with an equipment grounding conductor. Only extension cables which meet the relevant standards and also have an equipment grounding conductor may be used. Intentional disconnection of the equipment grounding conductor is prohibited.



**The Halogen Moisture Analyzer works with heat!**

- Ensure sufficient free space around the instrument to avoid heat accumulation and overheating (approx. 1 m free space above the instrument).
- The vent over the sample must never be covered, plugged, taped over or tampered with in any other way.
- Do not place any combustible materials on, under or next to the instrument when it is connected to the power supply, since the area around the heating module becomes hot.
- Exercise caution when removing the sample. The sample itself, the automatic sample chamber and any sample vessels used may still be very hot.
- During operation, you should never open the heating module as the ring-shaped heating module or its protective glass can reach 400 °C! If you have to open the heating module on occasion, disconnect the instrument from the power supply and wait until the heating module has cooled down completely.
- No modifications must be made within the heating module. It is particularly dangerous to bend any components or remove them, or to make any other changes.

Certain samples require special care!

With certain types of samples, there is a possibility of danger to personnel or damage to tangibles through:

**Fire or explosion:**

- Flammable or explosive substances
- Substances containing solvents
- Substances which evolve flammable or explosive gases or vapors when heated.

With such samples, work at a drying temperature that is low enough to prevent the formation of flames or an explosion and wear protective goggles. Should there be any uncertainty regarding the flammability of a sample, always work with a small amounts of sample (max. 1 gram). In such cases, **never leave** the instrument **unattended!** In cases of doubt, perform a careful risk analysis.

Poisoning, burning:

- Substances which contain toxic or caustic components. Such substances may be dried only in a fume cupboard.

Corrosion:

- Substances which evolve corrosive vapors when heated (e.g. acids). In the case of such substances, we advise you to work with small amounts of sample as the vapor can condense on cooler housing parts and cause corrosion (if necessary, the heating module can be changed very easily by the user, see Section 7.6).

Please note that the user always takes responsibility and assumes liability for damage caused by use of the types of samples mentioned above!

- Never make any modifications or constructional alterations to the instrument and use only original spare parts and optional equipment from METTLER TOLEDO.
- Your Moisture Analyzer is a rugged precision instrument – but you should still treat it carefully; it will then thank you with many years of trouble-free operation.

- **Please comply with all notes and instructions in these operating instructions. Keep the instructions in a safe place where they are immediately to hand if any points are unclear. If you lose these instructions, please contact your METTLER TOLEDO dealer for an immediate replacement.**



Moisture determination applications must be optimized and validated by the user according to local regulations. Application-specific data provided by METTLER TOLEDO is intended for guidance only.

1.4 Disposal



In conformance with the European Directive 2002/96/EC on Waste Electrical and Electronic Equipment (WEEE) this device may not be disposed of in domestic waste.

This also applies to countries outside the EU, per their specific requirements.

Please dispose of this product in accordance with local regulations at the collecting point specified for electrical and electronic equipment.

If you have any questions, please contact the responsible authority or the distributor from which you purchased this device.

Should this device be passed on to other parties (for private or professional use), the content of this regulation must also be related.

Thank you for your contribution to environmental protection.

1.5 Important information for these instructions

These instructions guide you step by step through the operation of your Moisture Analyzer. The first two Sections help you put the instrument into operation quickly, safely and properly and perform your first measurement within a short space of time. In Sections 3 through 6 you become intimately acquainted with the wide range of functions of your Moisture Analyzer. During this learning phase, you will find the table of contents and the detailed index in Section 10 a valuable orientation aid. Sections 7 through 9 contain additional information on the maintenance of your instrument, troubleshooting and the available options. As soon as you are familiar with your Moisture Analyzer, you will find the illustrations at the beginning of these instructions and the associated references (in the key) useful for quick access.

The following identifications and symbols are used in these instructions:

- Key designations are shown enclosed by twin angle brackets «». Keys with inscribed text are shown with the actual inscription (e.g. «On/Off» or «Start»). For all keys with symbols, designations are used in the text which describe the function of the particular key («Print», «Accept entry» or «Scroll down»).
- This symbol indicates safety and hazard instructions. If these are not complied with, injury to the user, damage to your instrument or other tangibles and malfunctions can result.



- This symbol indicates additional information and directions which facilitate your handling of the instrument and contribute to proper and economical use.

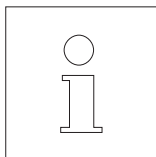

These instructions are also available in foreign languages. Should you require a set of instructions in a different language, please contact your METTLER TOLEDO dealer. You will find the address of your nearest dealer in the attached "Declaration of Conformity 11780294".

2 Your first measurement in next to no time

In the Section you will learn how to put your new Moisture Analyzer into operation and obtain measurement results within a very short space of time.

2.1 Unpacking and checking the standard equipment

Open the package and remove the instrument and the accessories. Check the completeness of the delivery. The following accessories are part of the standard equipment of your new Moisture Analyzer:

- 80 aluminum sample pans
- 1 sample holder
- 1 sample handler
- 1 specimen sample (circular, absorbent glass fiber filter)
- 1 draft shield element
- 1 power cable
- 1 set of operating instructions, 1 set of short-form operating instructions
- 1 Application brochure “Methods of moisture content determination”
- 1 EC declaration of conformity (in separate brochure 11780294)
- Setup instructions

Remove the wrapping from the instrument.

Check the instrument for transport damage. Immediately inform your METTLER TOLEDO dealer if you have any complaints or parts are missing.

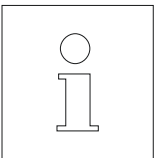

Store all parts of the packaging. This packaging guarantees the best possible protection for the transport of your instrument.

To prevent transport damage, the instrument is provided with a **transport arrestment**, which you have to remove before putting the instrument into operation for the first time. The procedure for removing the transport arrestment is explained in the description “Setup instructions 11780556” enclosed with the package.

2.2 Selecting the location

Your Moisture Analyzer is a precision instrument. An optimum location guarantees accuracy and dependability:

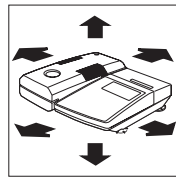
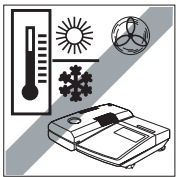
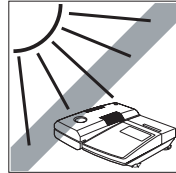

- Firm, horizontal location as free from vibrations as possible
- Avoid direct sunlight
- No excessive temperature fluctuations
- No powerful drafts
- Surroundings as free from dust as possible
- Adequate free space at the front for opening the sample chamber and sufficient clearance around the instrument to allow warm air to dissipate.
- Sufficient distance from heat-sensitive materials in the vicinity of the instrument.

2.3 Setting up, leveling and connecting to power supply

Exact horizontal positioning and stable installation are prerequisites for repeatable results. To compensate small irregularities or inclinations ($\pm 2\%$) at the location, the instrument can be leveled.

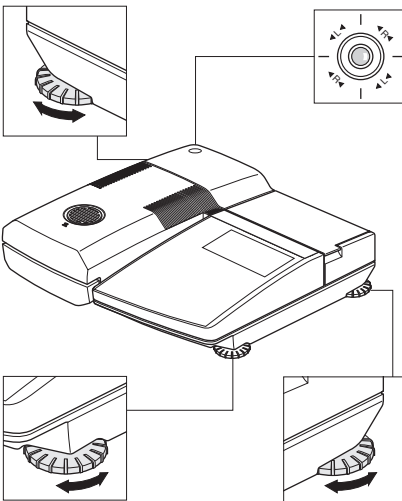

For exact horizontal positioning, the Moisture Analyzer has a level indicator (level) and 3 leveling screws. As soon as the air bubble is precisely in the middle of the cross hairs, the instrument is exactly horizontal. To level it, proceed as follows:

Position your Moisture Analyzer at the selected location.

Screw in the right front leveling screw completely (it is not needed for leveling). The instrument is now standing on the front left, nonadjustable foot, as well as on the two rear leveling screws.

Turn the two **rear** leveling screws until the air bubble is located in the middle of the level indicator. The arrows and the leveling screw designations (R = right rear leveling screw, L = left rear leveling screw) on the cross hairs will facilitate the setting:

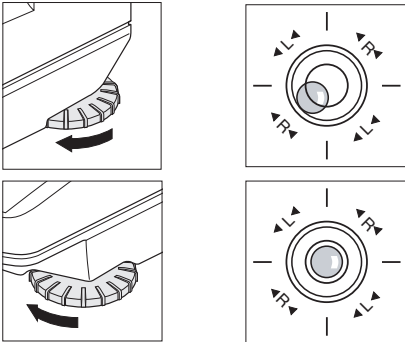

If the air bubble is located at the bottom left, for instance, the inscription indicates the right leveling screw must be turned in a clockwise direction. Unscrew the front right leveling screw until it contacts the support and the instrument is resting firmly on all 4 feet. Ensure that the air bubble remains in the center of the level indicator.

Note: The instrument should be leveled each time its location is changed.

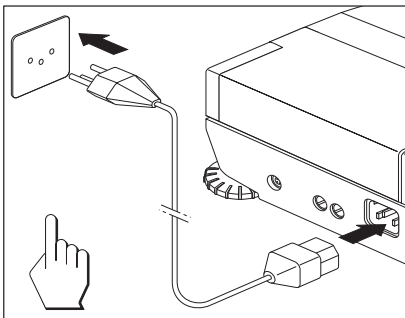

Connect the instrument to the power supply.

Warning:

If the power cable supplied is not long enough, use only a **3-pin extension cable with equipment grounding conductor!**

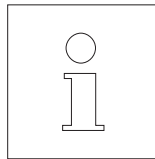

For technical reasons, the halogen heating module is designed specifically for a particular line voltage (110 V AC or 230 V AC). A heating module is installed in the factory that is matched to the particular line voltage of the country of destination. If you are not sure whether the heating module built into your instrument is suitable for your local line voltage, check the voltage data in the interior of the heating module before you connect the Moisture Analyzer to the power supply!



Connection to a line voltage that is too high can lead to blowing of the fuses, whereas a supply voltage that is too low will prolong the drying process.

Ensure that the transport arrestment is removed. Instructions on how to remove the transport arrestment can be found on the leaflet enclosed with the package.



Switch the instrument on with the «On/Off» key.

Note: When putting into operation for the first time, leave the instrument connected to the power supply for at least 5 hours to allow the built-in battery to charge up! If the instrument is later disconnected from the power supply for several months, the battery will become discharged. This leads to data loss. To recharge the battery, leave the instrument connected to the power supply for at least 5 hours.



Press the «Open/close auto sample chamber» key and ...

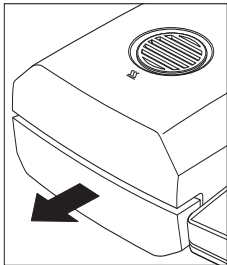

... the motorized, automatic sample chamber opens.

Always ensure **sufficient free space in front of the instrument** since the emerging automatic sample chamber could knock over objects in its path or push them off the bench.

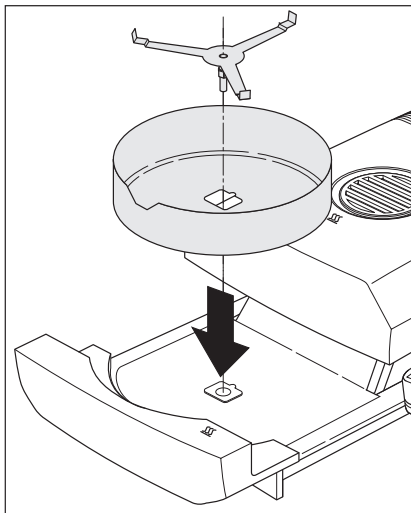

Install the draft shield element (only one position possible) and then the sample pan holder. Turn the sample pan holder until it engages. In the locked position, the rear arm of the sample pan holder points exactly in the direction of motion of the automatic sample chamber.



Press the «Open/close auto sample chamber» key and ...

... the motorized, automatic sample chamber closes.

2.4 Preparing the printer

If your Moisture Analyzer is not equipped with a built-in printer, there is no need to read this section. You can always order the built-in printer at a later date and install it yourself.

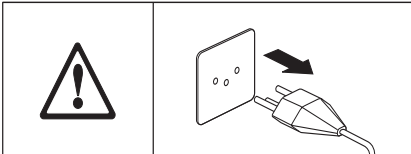

You can prepare the built-in printer for use as follows:

Disconnect the instrument from the power supply.

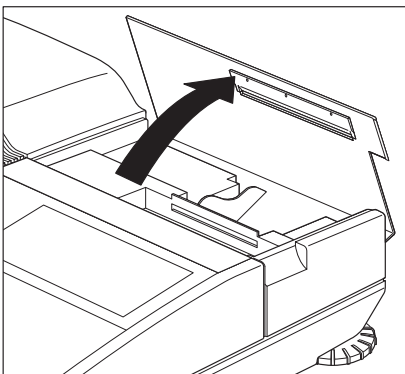

Swing back the cover of the printer.

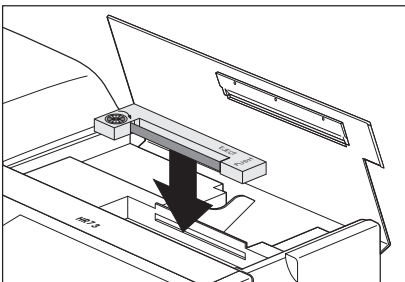

Insert the ribbon cassette in the printer and press it down until you hear it click into place.

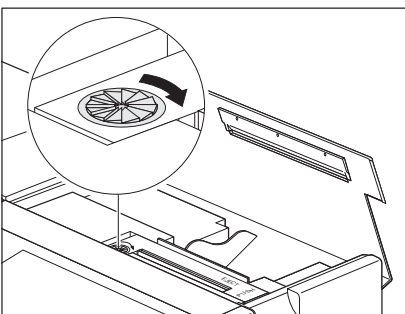

Tension the ribbon by turning the small wheel on the left of the cassette in the direction shown by the arrow.

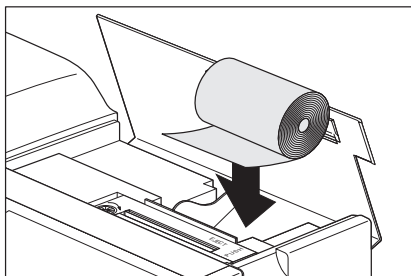

Place the roll of paper in the paper compartment and feed the paper horizontally through the slot at the back of the printing unit.



Connect the instrument to the power supply and switch it on with the «On/Off» key. Press the «Paper feed» key until the leading edge of the paper exits the printing unit at the top.

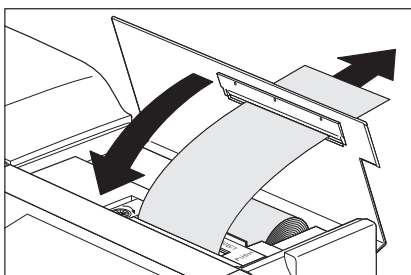

Lead the paper through the slot in the cover of the built-in printer and close the cover.

2.5 Setting the date and time

Your Moisture Analyzer prints out the date and time on every record. When you put your new instrument into operation for the first time, you should enter the current date and the time. These settings are retained even if you disconnect your instrument from the power supply.

In this Section you will enter the menu for the first time, although this is described in detail in a later section. Do not worry if you have to press keys whose function you are not familiar with, simply follow the instructions step by step. We describe the menu in detail in Section 6.

Note: Various languages are available for the dialog with your instrument and can be selected in the menu. You will find further details on language selection in Section 6.17.



Press the «On/Off» key to switch the instrument on.

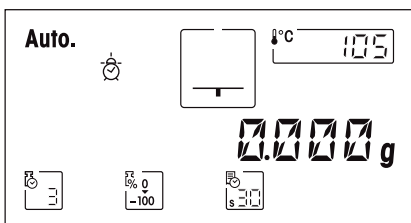

After it has been switched on, the instrument performs a self-test. Wait until the display shown opposite appears.

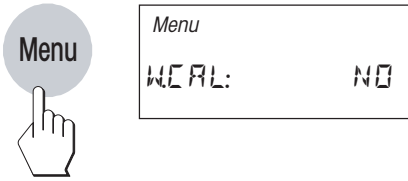

Press the «Menu» key. You are now already in the menu.

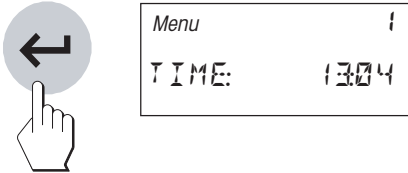

Press the «Accept entry» or «Menu» key repeatedly until the display shown opposite for entry of the time appears.

Important: Do not press any other key, otherwise you could possibly change the factory settings of your instrument!

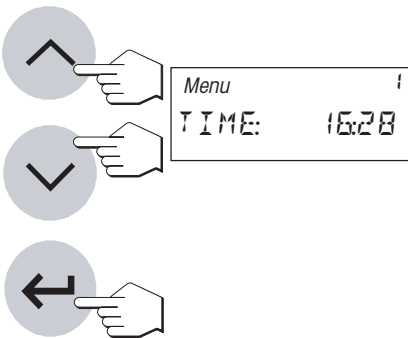

Use the «Scroll up» and «Scroll down» keys to set the time (00:00–23:59). By pressing and holding the keys you can accelerate the change in the time. Confirm your setting with the «Accept entry» key. The instrument stores the time.

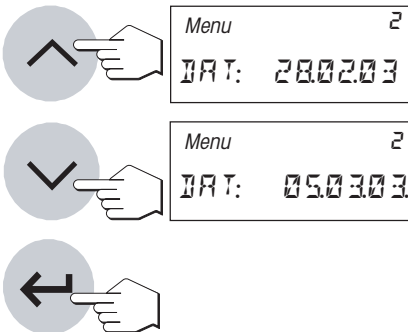

After confirmation of the time, the display for entry of the current date appears. Use the «Scroll up» and «Scroll down» keys to set the date in the format “Day – Month – Year” (DD.MM.YY). By pressing and holding the keys you can accelerate the change in the date. Confirm your entry with the «Accept entry» key and the instrument stores the date.

Note: With US English as the dialog language, the following applies to entry of the date format “Month – Day – Year” (MM/DD/YY).

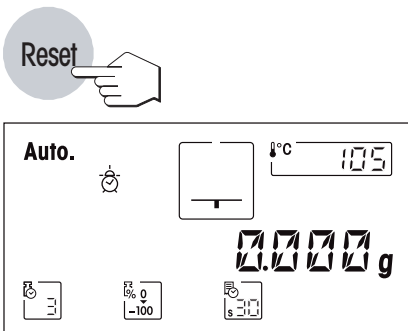

This completes your entry of the date and time, and you can now quit the menu by pressing the «Reset» key. Your settings are stored and remain so even in the event of a power failure. The Moisture Analyzer is now ready for your first measurement.

2.6 Your first measurement

After you have successfully put your new Moisture Analyzer into operation for the first time, you can immediately perform your first measurement. In doing so, you will become familiar with the instrument and the status display and at the same time perform a function check.

Please use the specimen sample supplied for your first measurement. This sample is an absorbent glass fiber filter. During your first measurement, the instrument operates with the factory settings.

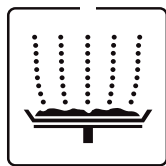

Your Moisture Analyzer has a novel graphical status display (User guide) which you will become acquainted with in this section. The status display informs you continuously about the current status of the instrument and prompts you to execute the next operating step (shown flashing).



Switch the instrument on with the «On/Off» key.

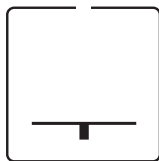

Initial status with closed automatic sample chamber.



Press the «Open/close auto sample chamber» key and ...

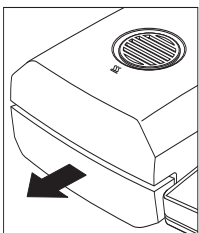

... the motorized, automatic sample chamber opens.



Always ensure **sufficient free space in front of the instrument** since the emerging automatic sample chamber could knock over objects in its path or push them off the bench.

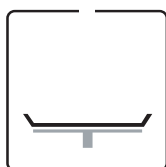

Status: Ready for taring

The status display flashes and prompts you to load the empty sample pan and tare.

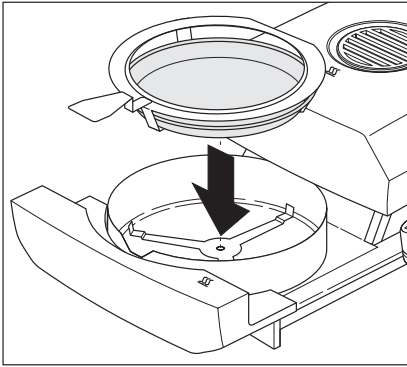

Place the empty sample pan in the sample pan handler (this is possible without tilting the sample pan if you insert this in the pan handler from the side directly below the round flange). Place the sample pan handler in the automatic sample chamber. Ensure that the tongue of the pan handler fits exactly in the slot of the draft shield element. The sample pan must lie flat in the pan holder.

Note: We advise you to work with the sample pan handler at all times. The pan handler is ergonomic, safe and provides protection against possible burns due to the hot sample pan.



Press the «Tare (zero)» key. This sets the balance installed in the Moisture Analyzer to zero. For taring, the automatic sample chamber closes briefly then opens again.



Status: Ready for weighing

After taring, the status display flashes and prompts you to place the sample in the sample pan.

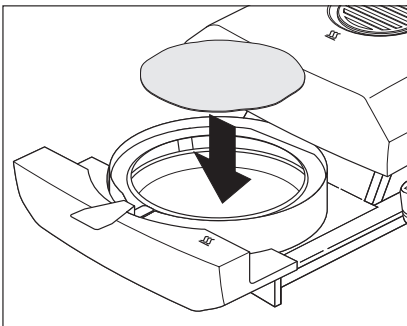

Place the specimen sample in the sample pan.

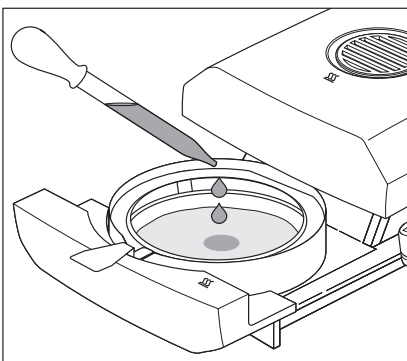

Wet the specimen sample with a few drops of water.

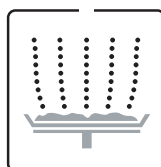

Status: Ready for start

The status display flashes and prompts you to start the drying process.



Press the «Start» key and ...

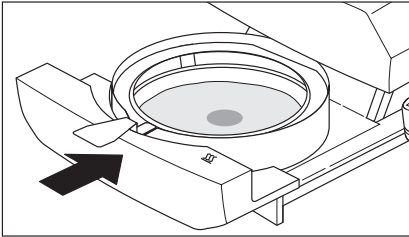

... the motorized, automatic sample chamber closes. The instrument starts the drying and measurement.

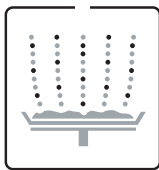

Status: Drying and measurement

You can follow the drying and measurement process in the display:

- The status display uses rising bubbles to symbolize the drying process.
- The current temperature in the heating module is displayed as well as the elapsed drying time and the current drying value.
- Further, the display shows information on the selected settings. You will find additional information on the meaning of the displays and the various setting possibilities in Section 4. If your instrument has a built-in printer, the measurement results will be printed out continually (at intervals of 30 seconds).

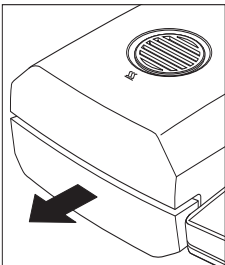
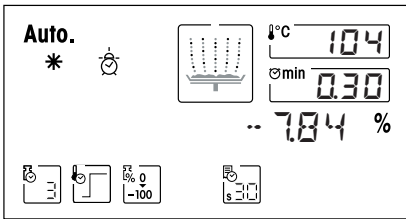

At the end of the drying time, an audio signal sounds and the sample chamber is automatically opened.



Warning: Sample pan and sample are still hot!

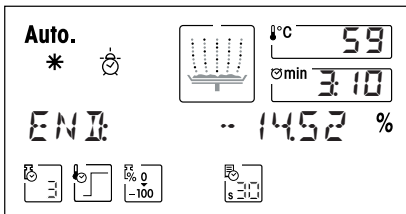

You can now read off the **moisture content** of your sample in the display.

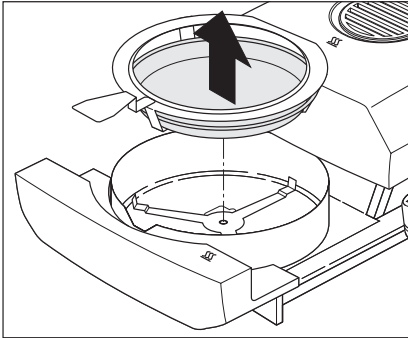

Carefully remove the sample pan handler from the automatic sample chamber.



Warning: As the pan and sample may still be hot, you should let these cool down before removing the pan from the handler!

To remove the sample pan from the handler, lift the pan slightly from below and pull it sideways out of the handler (if you no longer need the sample and the pan, you can simply tilt the handler until the pan slides out).



Press the «Reset» key to delete the measurement result from the display. The instrument is now ready for the next measurement. If you do not wish to perform another measurement, press the «Open/close auto sample chamber» key. The automatic sample chamber closes.

Congratulations!

You have just performed your first measurement with your new Moisture Analyzer. In the following section you will find important information on the operating principle of your instrument, its calibration and optimum preparation of your samples.

Notes on the automatic sample chamber

- Before every automatic closure of the automatic sample chamber, an audio signal sounds.
- For reasons of safety, the open automatic sample chamber is automatically closed after 2 minutes. If a weight change occurs or a key is pressed during this time, the 2 minute period starts over again.

3 How to obtain the best results

Following your first practical work with the Moisture Analyzer, in this Section you will find important information on how to obtain optimum results. You will discover what parameters influence the measurement process and how you can match the instrument optimally to your particular measurement task.

3.1 Measurement principle of the Halogen Moisture Analyzer

Your instrument performs measurements based on the **thermogravimetric principle**, i.e. the moisture is determined from the weight loss of a sample dried by heating.

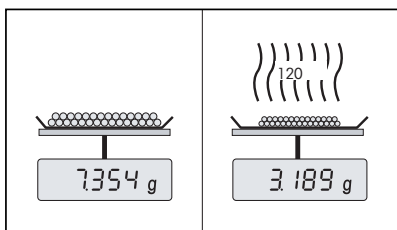

In principle, your instrument thus comprises two instruments: a precision balance and a heating module. In contrast to other thermogravimetric methods (drying oven, infrared, microwave), the Halogen Moisture Analyzer operates with a halogen heating module. This ensures fast heating of the sample and thus guarantees rapid availability of the measurement results.

Irrespective of the measurement method, the quality of the measurement results stands or falls by the **preparation of the sample** and **a correct choice of the important measurement parameters**:



- Sample size
- Drying temperature
- Switchoff mode
- Drying time

Inappropriate setting of these parameters can cause the results to be incorrect or misleading. For this reason, check that the results for each type of sample are what might reasonably be expected.

You will find detailed information on the relationships between these parameters in the application brochure for moisture determination (see Section 9.3), enclosed to your instrument.

In practice, however, not only the quality of the measurement results, but also the **speed of the measurement process** is important. Thanks to its drying principle (with the heat generated by a halogen radiator), the Halogen Moisture Analyzer is very fast. You can increase the speed even further through optimum setting of the instrument.

The **optimum drying temperature and the drying time** are dependent on the nature and size of the sample and on the desired accuracy of the measurement results. These can be determined only by experiment. The Halogen Moisture Analyzer supports you in this task: It offers **automatic performance and result recording of test measurements**.

3.2 Notes on adjustment of the balance and the heating module

You should adjust your Moisture Analyzer regularly (e.g. every six months) if this is stipulated by your quality assurance system (e.g. GLP, GMP, ISO 9001).

The balance and the integral heating module in your instrument can be adjusted using the appropriate accessories (see Section 9.8). The heating module and balance can also be tested (to check the adjustment). The operator can define a test weight or the test temperature, together with permissible tolerances for this test. A test report is printed out showing the test result as "Passed" or "Failed" (see Section 6.3 and 6.5).

By adjusting the heating module you can ensure comparability with results from other instruments of the same design. This is done by using an appropriate thermometer, which is provided in the form of a temperature adjustment set with calibration certificate (see Section 9.8). This adjustment set comprises a black plate with a thermometer, which allows a reproducible adjustment of the heating module.

A Moisture Analyzer is typically used in place of or in addition to the oven method. In an oven heat energy is transferred by the flow of air, which establishes an equilibrium between the sample temperature and the ambient temperature. This is not the case in a Moisture Analyzer. The actual sample temperature primarily depends on the specific absorption properties of the sample ("dark" samples absorb more heat), which can change during the measurement process. There can also be differences between the temperature at the surface of the sample and the temperature inside the sample. The heat output is therefore not dependent on the true sample temperature but instead is regulated by a temperature sensor underneath the halogen heating module.

For the reasons explained above, the temperature setting on the instrument will therefore deviate to the true sample temperature. By regularly adjusting the heating module, you will ensure a consistent and reproducible heat output for the entire lifetime of your instrument.

Note: METTLER TOLEDO offers an adjustment service – please contact your local dealer.

- If you also use your instrument as a high precision lab balance, you should adjust the balance at regular intervals.
- If you replace the heating module, you must adjust it using the temperature adjustment set, which is available as an accessory.

The procedure for adjusting the balance and heating module is described in Section 6.

3.3 Optimum sample preparation

Preparation of the sample is decisive for the speed of the measurement process and the quality of the measurement results.

Please note the following **basic rules** for the preparation of your sample:

The amount of sample you select should be as small as possible and only as large as necessary

Excessive amounts of sample require more time for drying and thus prolong the measurement process. If the amount of sample is too small, the measurement result may possibly not be representative. The following always holds: The greater the inhomogeneity of the sample, the larger the amount of sample needed to obtain a repeatable result (please see also the list in Section 9.1).

Distribute the sample evenly over the sample pan

You thus increase the surface area of the sample and facilitate heat absorption. The base of the pan should be evenly covered.

With liquid, fat-containing, melting and highly reflecting samples, you should cover the sample with the glass fiber filter available as optional equipment (HA-F1 214464, see Section 9.8). This also applies to samples which form a skin on their surface when heated. The glass fiber filter ensures even and rapid heat distribution and prevents the formation of a skin impervious to moisture on the sample surface.

3.4 Further information on moisture determination

You will find further information on the moisture determination, the importance of the parameters and the preparation of the samples in the **Application Brochure** "Methods of moisture content determination" dealing with moisture determination (see Section 9.3).

Useful tips and a variety of example methods (comparison between Halogen Moisture Analyzer results and the oven method) can be downloaded from **www.mt.com/moisture**.

If you require information on specific applications, your METTLER TOLEDO dealer will be pleased to help you.



Moisture determination applications must be optimized and validated by the user according to local regulations. Application-specific data provided by METTLER TOLEDO is intended for guidance only.

4 Practical application of your Moisture Analyzer

In this Section we introduce you to the wide range of setting possibilities of your Moisture Analyzer and offer information and tips for optimum setting of the parameters.

4.1 Operating principles

You already performed your first measurement in Section 2. This measurement was carried out using the factory settings. However, your instrument offers a number of setting possibilities to match the measurement process to your specific requirements. For instance, you can preselect the drying temperature, the type of result display and many other parameters.

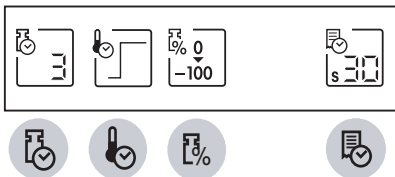

Settings are made using the function keys. These keys are right at the top of the keypad, directly below the display. The setting you select appears in the display directly above the associated key.

You will learn the available setting possibilities and the function keys in detail in the following Sections. Further, you will also discover how to set the drying temperature and the drying time and how to work with the weighing-in aid. Finally, you will perform a complete measurement with the specific settings for your sample.

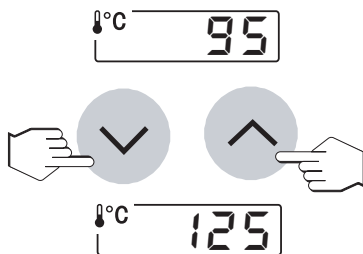

Numeric entries:

With some settings (e.g. the drying temperature), **numeric entries** are required. There are two different ways of entering numerical values:

You can change the flashing displayed value with the «Scroll up» or «Scroll down» key or ...



... You can enter the new value with the «0...9» key.



As soon as you have entered the desired value, press the «Accept entry» key. The value will be stored.

Preliminary information on the methods:

All settings for a sample which you will learn in the following Sections can be collected in a so-called "Method". You have 10 methods freely available thus giving you the possibility of defining a method for a particular sample and recalling it at any time. This eases the work load considerably as each time you switch to a different type of sample there is no need to repeat all the parameter settings. The methods are retained when the instrument is switched off. You will find information on the compilation and use of methods in Section 5.

4.2 Selecting the drying program

This function key offers you two different drying programs for optimum matching of the drying characteristics to the sample used.



Each time this key is pressed, the next program appears. After the fourth and last program, the first reappears in the display. As soon as you have selected the desired program, the setting is active and you do not have to confirm or store it.



Standard drying

This **drying program** is set in the factory and is suitable for most samples. The sample is heated to the drying temperature (set temperature) and held constant at this temperature.



Rapid drying

This program is primarily suitable for **samples with a moisture content over 30%**. Following the start, the selected temperature is **exceeded** by 40% for 3 minutes to compensate the cooling due to vaporization and accelerate the drying process. The drying temperature is then lowered to the set value and maintained. You will find details on how to enter the drying temperature in the Section 4.3.

4.3 Setting the drying temperature



After pressing this key you can enter the drying temperature (set temperature).

The type of entry depends on the selected drying program (see Section 4.2). If you have selected one of the programs "Standard drying" or "Rapid drying", you need enter only the drying temperature.

Selecting drying temperature for standard drying and rapid drying

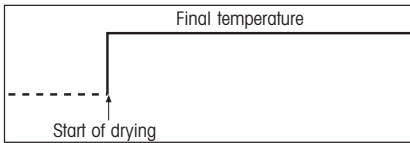

You need enter only the desired final temperature.

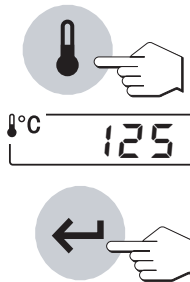

Press the «Drying temperature» key and enter the desired drying temperature (see Section 4.1).

- either with the «Scroll up» and «Scroll down» keys or
- with the «0...9» key.

Press the «Accept entry» key.

Note: The admissible input range for temperatures is 40 °C–200 °C.

Temperature limitation

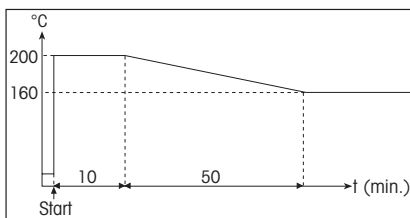

With regard to high temperatures, the moisture analyzer has several protective mechanisms that work independently of each other:

- At temperatures above 160 °C a time limit becomes active. The higher the temperature, the shorter the time until the instrument starts to lower the temperature (envelope curve, see illustration opposite). **Note:** If necessary, this time-controlled lowering of the temperature can be deactivated in the Methods menu (Section 5.4). If deactivated, temperatures from 160 °C - 200 °C are available without time limitation.
- A temperature switch independent of the normal black temperature sensor over the sample (see Section 7.1) is triggered when it detects exceptionally high temperatures. This situation could arise, for example, if the sample begins to burn or the temperature calibration is defective. If this happens, the heating module is tripped out by a mechanical switch, and the instrument cannot be restarted. Please refer to Section 8.3 for troubleshooting.

When working with temperatures over 180 °C we recommend that you always wait 2 - 3 minutes between individual measurements, in order to ensure good reproducibility of the readings.

Note: A measurement cannot be started until the drying temperature is higher than the temperature in the measuring room. This avoids a false start (Error 10, Section 8.2).

4.4 Selecting the switch-off criterion

This function key offers you different switch-off criteria. A switch-off criterion defines when the instrument should end the drying. Switch-off criteria save you having to keep checking your watch and stopping the drying manually.

The following settings can be selected for the switch-off criterion:

- "Weight loss per unit of time" (5 settings)
- "Free switch-off criterion" (if activated in the Methods menu, Section 5.4)
- "Manual switch-off"
- "Timed switch-off"
- "Test measurement" for determination of the suitable switch-off criterion



Weight loss per unit of time

This switch-off criterion is based on a weight loss per unit of time. As soon as the mean weight loss is less than a preset value during a specified time, the instrument considers drying as complete and automatically discontinues the measurement process. During the drying, the time display shows you how long the measurement process has been in progress. The switch-off criterion is inactive during the first 30 sec. You will find additional information in Section 9.4.

The following 5 settings are available:

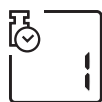
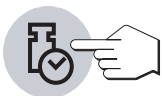

This setting is suitable for samples which dry very quickly (surface moisture) or for (relatively inaccurate) fast measurements to determine a trend.



This setting is suitable for quick drying samples.

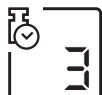

This is the **factory setting**. It is suitable for most types of samples.

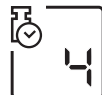

This setting is suitable for samples which dry moderately quickly.

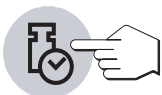

This setting is suitable for samples which dry very slowly (trapped moisture, skin formation).

Note: If you do not know the behavior of a sample, perform a test measurement to determine the suitable switch-off criterion. The procedure is described later in this section under the title "Test measurement".

Free switch-off criterion

This setting possibility is available only if you have activated it in the Methods menu (Section 5.4). There is one free switch-off criterion available for each method. The free switch-off criterion is based on a user-defined mean weight loss per unit of time.



You will find information on the activation and definition of the individual switch-off criterion in Sections 5.4.1 and 9.4.

Manual



With this switch-off criterion the measurement process continues until you stop it with the «Stop» key.

The time shown in the display tells you how long the current measurement has been in progress.

Timed switch-off



With this switch-off criterion the measurement lasts until the preset drying time has elapsed (the time display provides you with continuous information on the drying time).



If you select this criterion, you must then enter the desired **drying time** as follows:



Press the «Drying time» key.



Enter the desired drying time.

Press the «Accept entry» key.



Test measurement

Press T to perform a test measurement which will help you to determine suitable switch-off criteria (Section 4.11).

4.5 Selecting the display mode

With this function key you can select the desired type of result display. You also define what values are printed on the records.

The following display modes are available:

Moisture content

The moisture content of the sample is displayed (and printed out) as a percentage of the wet weight (= ww = initial weight = 100%). This is the **factory setting**.

When the results are printed out, the moisture content is marked by "%MC" (**M**oisture **C**ontent) (e.g. -11.35 %MC) and shown as a negative value.

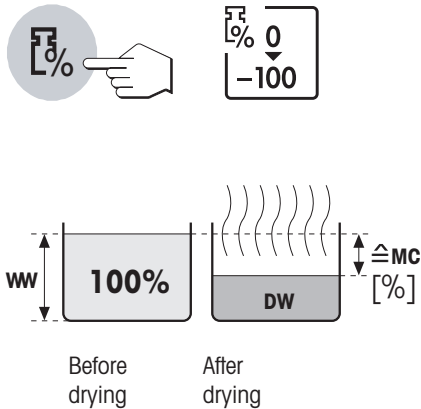

$$MC [0...100\%] = - \frac{\text{Wet weight } WW - \text{Dry weight } DW}{\text{Wet weight } WW} * 100\%$$

During the drying the current measured value is continuously displayed in percent.

Dry content

The dry content of the sample is displayed (and printed out) as a percentage of the wet weight (= ww = initial weight = 100%).

When the results are printed out, the dry content is marked by "%DC" (**D**ry **C**ontent) (e.g. 88.65 %DC).

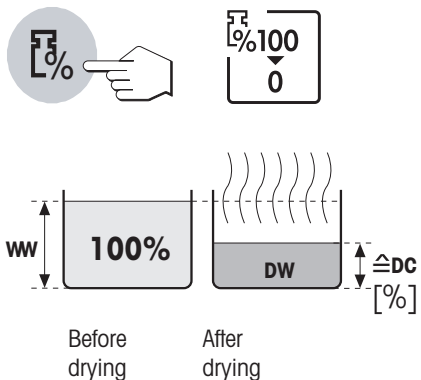

$$DC [100...0\%] = \frac{\text{Dry weight } DW}{\text{Wet weight } WW} * 100\%$$

During the drying the current measured value is continuously displayed in percent.

Weight in grams

The weight of the sample is displayed (and printed out) in grams. With this setting, the Moisture Analyzer is used as a precision balance.

During the drying the current weight is continuously displayed in grams.



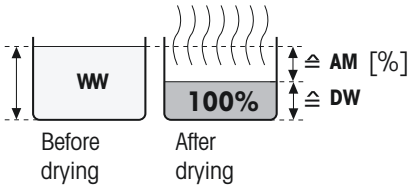

ATRO moisture content

The moisture content of the sample is displayed (and printed out) as a percentage of the dry weight (= DW = final weight = 100%).

When the results are printed out, the ATRO moisture content is marked by “%AM” (ATRO Moisture Content) (e.g. -255.33 %AM) and shown as a negative value.

$$AM [0...-1000\%] = - \frac{\text{Wet weight } WW - \text{Dry weight } DW}{\text{Dry weight } DW} * 100\%$$

During the drying, the current measured value is continuously displayed in percent.

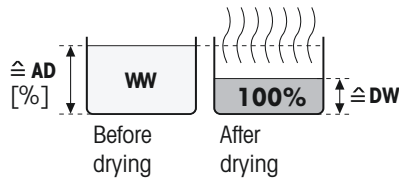

ATRO dry content (Wet weight)

The wet weight of the sample is displayed (and printed out) as a percentage of the dry weight (= DW = final weight = 100%).

When the results are printed out, the ATRO dry content is marked by “%AD” (ATRO Dry Content) (e.g. 312.56 %AD).

$$AD [100...1000\%] = \frac{\text{Wet weight } WW}{\text{Dry weight } DW} * 100\%$$

During the drying, the current measured value is continuously displayed in percent.

Comment on the ATRO display mode

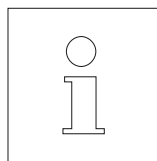

If the current measured value in the ATRO display mode is greater or less than the predefined limit value (i.e. greater than 999.99 %AD or less than -999.99 %AM), a warning beep sounds and the instrument automatically switches the display mode (from %AM to %MC and from %AD to %DC). A display in the ATRO mode is no longer possible in this case, even if you have started your drying operation in the %MC, %DC or “g” (grams) display mode.

4.6 Defining the print interval

One point before we start: This setting possibility is available only if the built-in printer is activated in the menu (see Section 6.15).

The print interval determines the printout frequency of the intermediate results of an ongoing measurement.



The following settings are available under this function key:

Printout at intervals

These 6 settings allow printout of the intermediate results at fixed, preset intervals. You can thus trace the drying process using the printed record. The following print intervals are available:



- Printout **every 5 seconds**
- Printout **every 10 seconds**
- Printout **every 30 seconds (factory setting)**



- Printout **every minute**
- Printout **every 2 minutes**
- Printout **every 10 minutes**



Manual printout

With this setting there is no automatic printout. However, you can print out the intermediate results at any time with the «Print» key.

4.7 Working with the weighing-in aid

The weighing-in aid can be defined for each method and facilitates weighing in of the sample to a preset weight value (target value). This is particularly useful if you require all the samples you wish to process to have same weight in order to improve the repeatability of the measurement results. In addition, the weighing-in aid can be configured so that the drying process cannot be started if the weight of sample is outside the set tolerance. You are therefore compelled to weigh in the correct quantity of sample ("Weighing-in aid active").

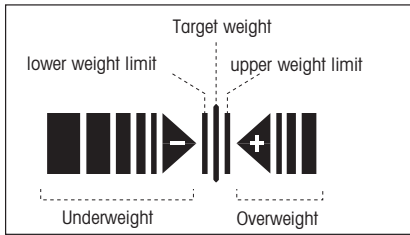

The weighing-in aid in the bottom right corner of the display comprises two opposite facing bars and triangles with a minus or plus symbol.

The weighing-in aid is available only if it has been activated. If the minus or plus symbol is visible after taring, the weighing-in aid is activated.

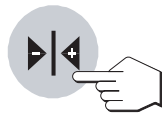
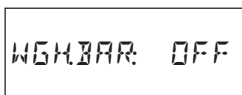

If you want to switch on the weighing-in aid, press the «Target weight (Weighing-in aid)».

In the factory the weighing-in aid is switched off ("OFF").

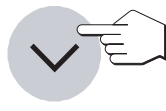

You can use the «Scroll up» and «Scroll down» keys to select either the "Weighing-in aid passive" or "Weighing-in aid active" setting.

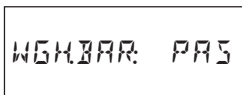

If the "Weighing-in aid passive" setting is selected, the weighing-in aid is switched on and a target weight can be defined. With this setting the drying process can be started even if the sample weight lies outside the set limits. These are defined by the target weight and the sample weight tolerance as a % of the target weight (see below).

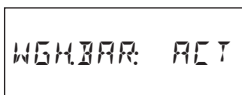

With the weighing-in aid set at "Weighing-in aid active" the drying process cannot be started if the sample weight is outside the set limits. You are therefore compelled to weigh in the correct quantity of sample, and are prevented from inadvertently starting the drying process with the wrong sample weight.

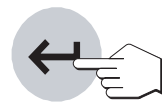

After selecting the desired mode for the weighing-in aid, confirm your selection by pressing the «Accept entry» key.

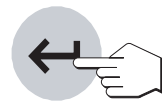
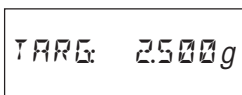

Enter the desired target weight (0,100 g to 80,000 g) (**Factory setting: 2.5 g**) and confirm with the «Accept entry» key.

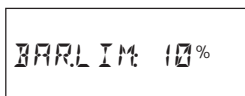

You can now use the «Scroll up» and «Scroll down» keys to define the sample weight tolerance in the range 1% to 25%. The sample weight tolerance (**Factory setting: 10%**) defines the lower and upper sample weight limits. Confirm your entry with the «Accept entry» key.

The symbols of the weighing-in aid appear in the display after you have tared the balance.

How the weighing-in aid operates

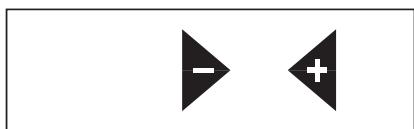

Before the start of weighing (standby mode)

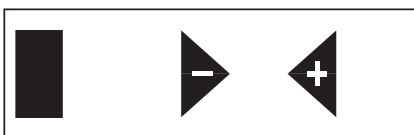

Start of weighing (sample weight too low)

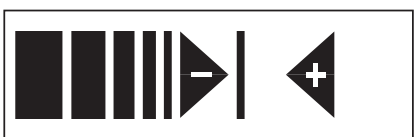

Lower weight limit reached (sample weight in tolerance range). The status display (user guide) indicates with its flashing 'rising bubble' graphic that the instrument is ready to run.

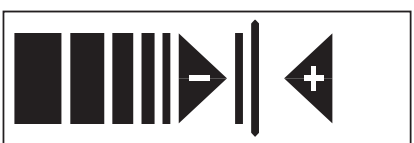

Target weight reached (sample weight in tolerance range). The status display (user guide) indicates with its flashing 'rising bubble' graphic that the instrument is ready to run.

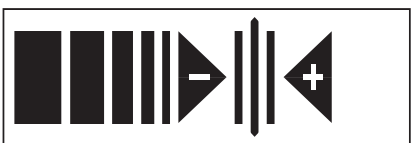

Upper weight limit reached (sample weight in tolerance range). The status display (user guide) indicates with its flashing 'rising bubble' graphic that the instrument is ready to run.

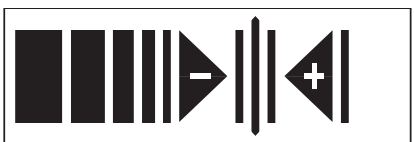

Upper weight limit exceeded (sample weight too high)

After initiation of the measurement with the «Start» key, the bars of the weighing-in aid disappear.

4.8 Comment line

You have the possibility of adding a freely defined comment to your measurement records. The alphanumeric comment line can contain up to 20 characters and is method-specific. To enter a comment, proceed as follows:

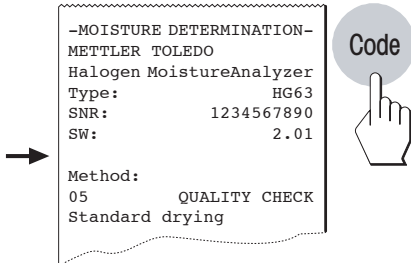

Press the «Code» key. The input field for the record header comment appears. If a comment has been entered previously, it appears in the display. The procedure for changing existing comments is described later. If you want to enter a new comment, **or completely overwrite an old one**, proceed as follows:



Press the «0...9» key. A flashing "1" appears at the first input position on the extreme left and signals that the instrument is ready for your entry.

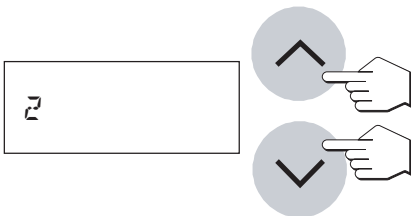

You can now use the «Scroll up» and «Scroll down» keys to select the first character of the comment or a special character (A...Z, +, -, etc.).



Confirm your selection with the «0...9»key. The flashing "1" again appears, but at the second position.

Enter a further character of the desired comment as described above.

Notes

- A space is symbolized by an underline character " _".
- You can remove wrong characters with the «Delete» key and then correct your entry.

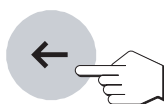

Changing a comment line

If you want to change an existing comment (e.g. increasing a sample number, entering a serial number), proceed as follows:



Press the «Code» key. The most recently saved comment appears.

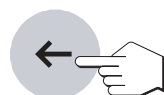

Press the «Delete» key. A flashing dash appears after the last character, indicating input mode.



With the «0...9» key you can then add further characters directly.

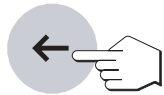

By pressing the «Delete» key a second time you can delete the last character. The second last character flashes and can be changed using the numeric keypad or the «Scroll up» and «Scroll down» keys, or confirmed with the «0...9» key. Further characters can then be added as described above.

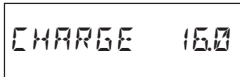

As soon as you have finished entering your comment, press the «Accept entry» key to quit the input mode (the flashing character will also be accepted). From now on your comment will be automatically printed out on each measurement record.

Displaying the comment line during measurement



By pressing the «Code» key you can display the current comment for 3 seconds during the drying.

4.9 Information on the measurement record

If your instrument has a built-in printer and this is activated in the menu, the intermediate values will be printed out at the preselected intervals and the final result recorded on completion of the measurement.

The measurement record contains the following data (from top to bottom):

```

A  ~~~~~
A  -MOISTURE DETERMINATION-
B  METTLER TOLEDO
   Halogen MoistureAnalyzer
C  Type:                HG63
D  SNR:                 1234567890
E  SW:                  2.01

F  Method:
   05

G           QUALITY CHECK
H  Switchoff mode  F
   1 mg /   35 sec
I  Standard drying
J  Drying temp.    105 °C
K  Disp.mode      0...-100 %MC
L  Start weight   2.507 g

M   1:00 min      -2.51 %MC
   2:00 min      -3.39 %MC
   3:00 min      -3.71 %MC

N  Total time     3:19 min
O  Dry weight     2.412 g
P  End result     -3.79 %MC

Q  ---30.06.03---15.14---

```

- A** Record title
- B** Manufacturer and Designation of the instrument
- C** Type of the instrument
- D** Serial number of the instrument
- E** Version number of the software
- F** Number of the selected method (see Section 5)
- G** Comment line
- H** Selected switch-off criterion (or set drying time)
- I** Selected drying program
- J** Drying temperature (set temperature)
- K** Selected display mode
- L** Sample weight at start of drying
- M** Measured value at each print interval (the number of recorded measured values depends on the selected print interval and the measurement time)
- N** Total time of drying
- O** Dry weight of the sample in grams
- P** Final result in the selected display mode
- Q** Date and time at the end of the measurement

Notes

- You will find information on the dimensions of the results (%**MC**, %**DC**, %**AM** and %**AD**) in Section 4.5.
- Depending on the settings in the Methods menu (Section 5.4), the data printout can contain other information, which is described in the relevant sections (Section 5.4.1 - 5.4.4).



```

0:20 min      -0.73 %MC
0:24 min      --->
0:28 min      <---
0:30 min      -0.86 %MC

```

Special events are recorded in the measurement record as follows:

In the manual operating mode of the automatic sample chamber, the sample chamber was opened and closed during the drying operation. When the automatic sample chamber is open, drying is interrupted and then continued when the chamber is closed.



```

7:30 min   -24.73 %MC
8:00 min   -24.55 %MC

>>>>>>> ABORT <<<<<<<<<
-----30.06.03-----15:26-----
    
```

The «Reset» key has been pressed. The drying process is **aborted** and the measurement result at the time of the abort is not evaluated as it could be wrong.



```

Total time      8:47 min
Dry weight     1.916 g
End result     -24.67 %MC

>>>>>>> MANUAL <<<<<<<<
-----30.06.03-----15:27-----
    
```

The drying process has been **stopped manually** with the «Stop» key. The elapsed drying time at the time of the stop and the measurement result are recorded. Please note that with manual stop the final result only shows the moisture content after the manually determined total duration.

4.10 Performing a measurement

You are now familiar with all the parameters of your Moisture Analyzer and have defined all values for your sample. The instrument is now ready for the determination of your own samples. In this Section you will learn how to perform measurements, print out the measurement results and stop the measurement process.



Switch the instrument on with «On/Off» key.

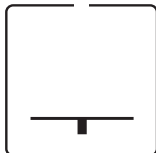

The status display (User guide) symbolizes the initial status of the instrument when the automatic sample chamber is closed.



Press the «Open/close auto sample chamber» key and ...

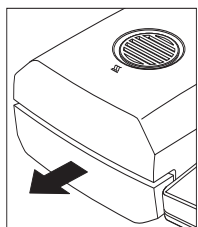

... the automatic sample chamber opens.



Always ensure **sufficient free space in front of the instrument** since the emerging sample chamber could knock over objects in its path or push them off the bench.

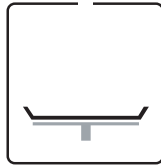

The status display (User guide) now prompts you to load the empty sample pan and tare the balance.

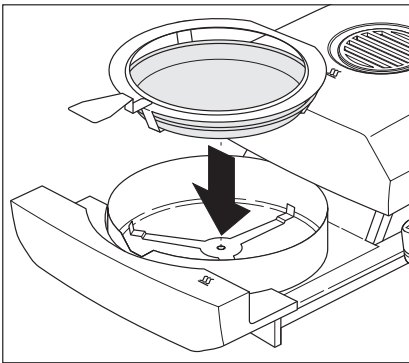

Position the empty sample pan in the sample pan handler. Place the sample pan handler in the automatic sample chamber. Ensure that the tongue of the sample pan handler lies exactly in the slot of the draft shield element. The pan must lie flat in the pan holder.

Note: We advise you to work with the sample pan handler at all times. The pan handler is ergonomic, safe and provides protection against burns due to the hot sample pan.



Press the «Tare (zero)» key. This sets the integral balance to zero. For taring the automatic sample chamber closes briefly then opens again.



Following taring, the status display prompts you to add the sample to the sample pan.

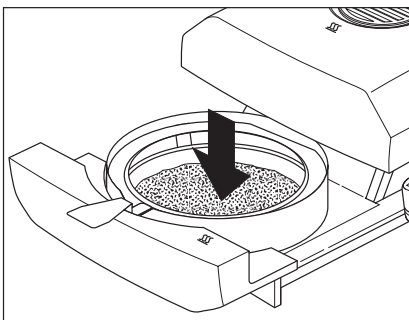

Add the sample to the sample pan. If you are working with the weighing-in aid, weigh the sample (minimum weight 0.1 g) using the bar display as explained in the Section 4.7.

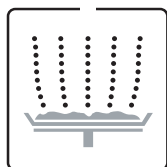

The status display now prompts you to start the drying process.



Press the «Start» key and ...

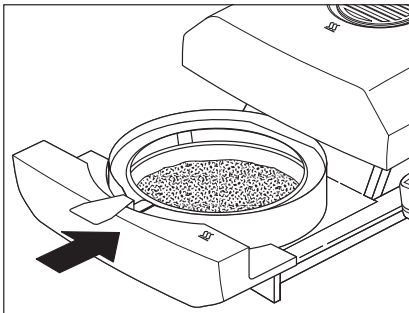

... the motorized, automatic sample chamber closes. The instrument starts the drying and measurement.

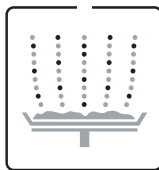

You can follow the measurement process in the display: The status display uses ascending bubbles to symbolize the drying process with the following values being continuously updated and displayed:

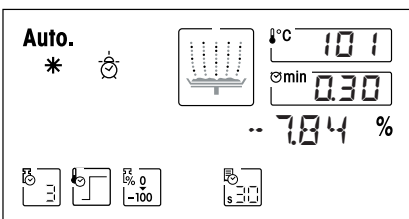

- **current temperature** in the heating module
Note: You can use the «Drying temperature» key to display the preselected drying temperature (current set temperature) for 2 seconds.
- **elapsed time** since the start of the measurement process
Note: If you have selected the switch-off criterion "Timed switch-off", the elapsed drying time will be displayed. You can display the preselected drying time for 2 seconds with the «Drying time» key.
- **current result** in the preselected display mode
 You can select a different display mode with the function key at any time even during the measurement.



If your instrument has the built-in printer and this has been activated, the measured values are printed out at the preselected intervals. You can use the «Print» key to output the intermediate result manually on the printer at any time. The units of the intermediate result are as defined in the preselected display mode and can therefore be changed during the drying process by pressing the «Display mode» function key. You will find an explanation of the measurement record in the Section 4.9.

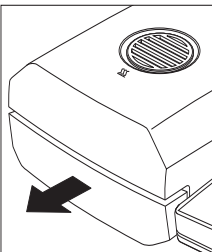

As soon as the preselected switch-off criterion is met (or the selected drying time has elapsed), an audio signal sounds. The measurement process is now ended and the sample chamber automatically opens.



Warning: Pan and sample may still be hot! Allow them to cool before you remove the pan from the handler!



Note: You can also manually **stop** the measurement process **prematurely** at any time by pressing the «Stop» key. With a measurement time of minimum 30 seconds or more, the result will be printed out at the time of the stop. If you **abort** a measurement process earlier or by using the «Reset» key, the measurement result will not be displayed.

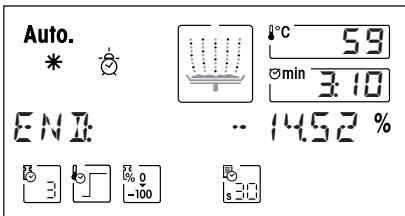

You can now read off the measurement result in the display. You will find information on the interpretation of the measurement results in Section 9.1. The result and time display remain at their final values, whereas the temperature continues to be updated.

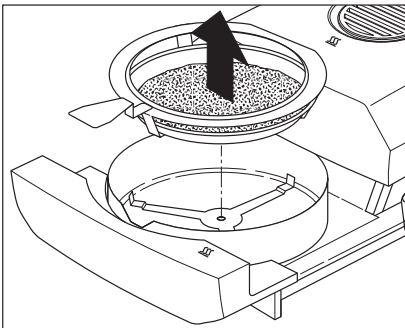

Carefully remove the sample pan handler from the automatic sample chamber.



Press the «Reset» key to delete the final result and the time display. The display can also be cleared with the «Tare/zero» key. This facilitates efficient working if the next empty sample vessel has already been loaded.



If you do not wish to perform another measurement, switch the instrument off with the «On/Off» key. After this operation, the sample chamber automatically closes.

4.11 Test measurement

You can use this function only if your instrument is fitted with a printer!

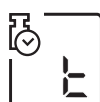

```

--- TEST MEASUREMENT ---
METTLER TOLEDO
Halogen MoistureAnalyzer
Type:                HG63
SNR:                 1234567890
SW:                  2.01

Method:
05

                QUALITY CHECK

Switchoff mode T
Standard drying
Drying temp.      120 °C
Disp.mode 0...-100 %MC
Start weight 2.543 g

    0:00 min    -0.00 %MC
    0:30 min    -1.96 %MC

    4:30 min    -13.80 %MC
    5:30 min    -14.39 %MC

Switchoff mode 1
Time            5:37 min
Result          -15.14 %MC
                -2.158 g

    7:00 min    -15.28 %MC
    7:30 min    -15.42 %MC

Switchoff mode 2
Time            7:42 min
Result          -15.81 %MC
                -2.141 g

    11:00 min   -16.56 %MC

Switchoff mode 5
Time            11:22 min
Result          -16.91 %MC
                -2.113 g

Total time      12:33 min
Dry weight      2.108 g
End result      -17.11 %MC

>>>>>>> MANUAL <<<<<<<<
-----30.06.03---15:28-----
    
```

If you wish to work with the switch-off criterion “Weight loss per unit of time” and are not familiar with the behavior of the sample, the test measurement will help you select the suitable setting.

The diagram opposite illustrates the progress of a drying. The points at which the individual switch-off criteria were reached (1–5) are marked.

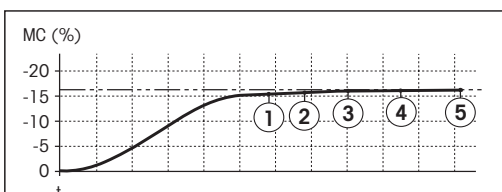

Test measurement procedure

Press “T” («Switch-off criterion» function key) to perform a test measurement. You perform a test measurement just like any other measurement. You will find further information on how to perform the measurement in Section 4.10.

Printing out the test measurement

During the test measurement a record is printed out which explains exactly when and with what measurement result each switch-off criterion was reached. The test procedure can be ended at any time with the «Stop» key. Automatic switch-off follows after a measurement time of 8 hours.

Note: Depending on the settings in the Methods menu (Section 5.4), the data printout can contain other information, which is described in the relevant sections (Section 5.4.1 - 5.4.4).

5 Methods facilitate your work

Methods simplify and accelerate your daily work. In this Section you will learn how you compile, print out and change methods and how to use them. You will find an overview diagram of all menu options in Section 5.4.

5.1 What is a method?

Perhaps you remember: In Section 4 you became acquainted with all the parameters and setting possibilities you can use to match your Moisture Analyzer to a particular measurement task. If you have to change samples frequently during your work, the methods save you having to reenter the parameters and preclude wrong settings. Methods thus make it easier for you to switch between different types of samples.

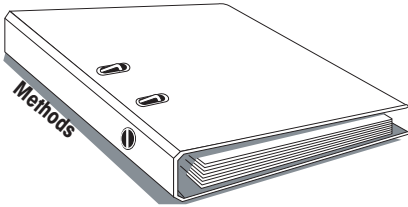

A method contains all **settings** for a particular sample. It can be recalled at a keystroke and your instrument immediately operates with the corresponding settings. You have 10 methods freely available.

The following parameters, which you have already learned in Section 4, form part of a method:

- Drying program
- Drying temperature
- Switch-off criterion
- Drying time (depends on switch-off criterion)
- Display mode
- Print interval
- Target weight for weighing-in aid
- Settings in the Method menu (Section 5.4)

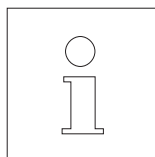
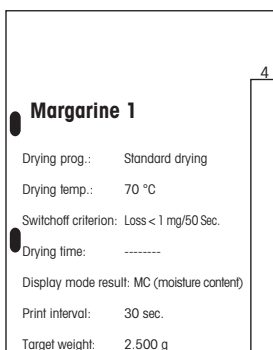
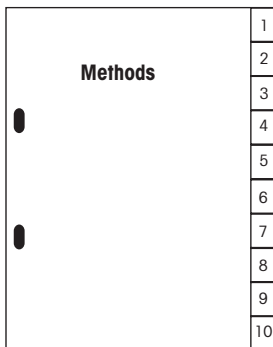

Work with methods is divided into two stages: in the **setting stage** you define the parameters of the method and name the method. In the **utilization stage** you perform routine measurements with different samples. When switching from one sample to the next, you do not have to change any settings, you need simply select the method suitable for the sample. You will find information on how to use and set up of methods in the following Sections.

5.2 Recalling a method

To activate all settings for a particular sample, simply call up the associated method. After recall of the method, all appropriate settings become immediately active.

To recall an existing method (consult the next section for information on how to compile methods), proceed as follows:

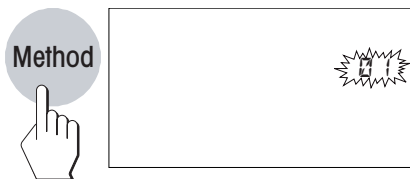

Press the «Method» key. The fixed method numbers (01-10) flash on the screen.

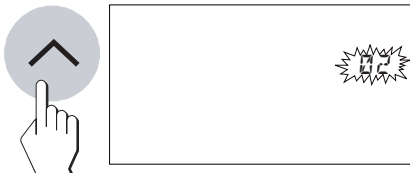

Now use the «Scroll up» and «Scroll down» keys to select the method. Then press the «Accept entry» key.

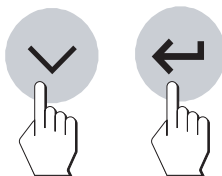

All settings of the selected method are now active and you can immediately perform your measurement.

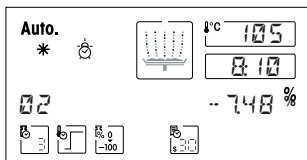

During the measurement the number of the active method (e.g. method number 02) is displayed.

5.3 Changing methods

When you put your Moisture Analyzer into operation for the first time, all 10 methods are identical and are allotted the factory setting for all parameters. You can change the parameters of a method at any time (except when a measurement is running or the settings are protected against change as described in Section 6.13).

The compilation of a new or the modification of an existing method comprises 2 steps:

- Selecting a method (01 - 10)
- Selection of the settings

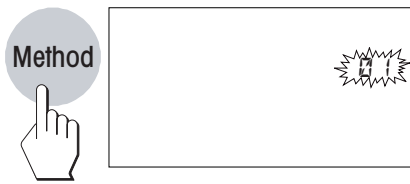

Selecting a method

Press the «Method» key.

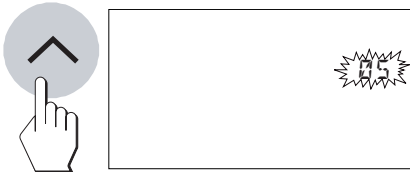

Now use the «Scroll up» and «Scroll down» keys to select the method you wish to change.



Selecting the settings

The selected method is now ready for the entry or change of the parameters.

Now use the appropriate keys to match the following parameters to your measurement task:

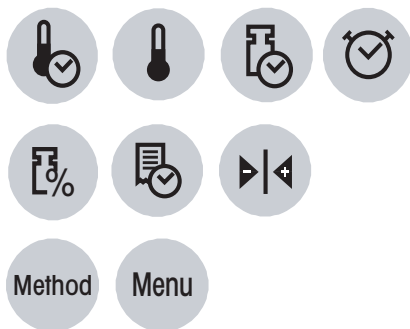

- Drying program
- Drying temperature
- Switch-off criterion
- Drying time (dependent on switch-off criterion)
- Display mode
- Print interval
- Target weight for weighing-in aid
- Settings in the Methods menu (Section 5.4)

Please consult Section 4 for the meaning of the individual parameters and details on how to proceed.

All settings are assigned to the selected method and automatically stored.

After you have completed all settings, your instrument is ready for measurement with the new or changed method.

Note

The methods can be protected in the menu against changes (see Section 6.13).

5.4 Method menu

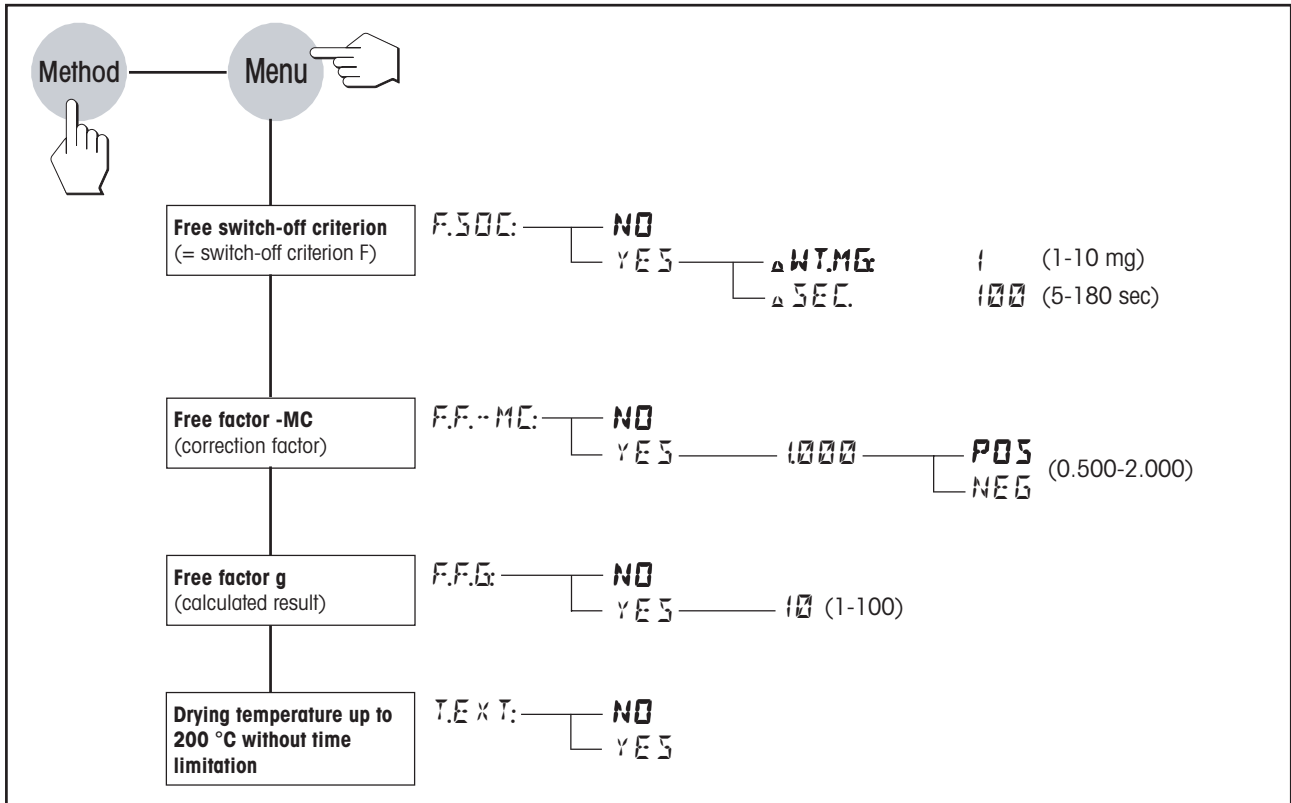

If you press the «Method» key followed by the «Menu» key, the Method menu opens (you will find additional information on using the menu in Section 6).

You can define the following settings here: Free switch-off criterion (1 mg to 10 mg / 5 sec to 180 sec), Free factor -MC (0.500 to 2.000), Free factor **F.F.G** (1 to 100) and drying temperature up to 200 °C without time limitation.



5.4.1 Freely selectable switch-off criterion

The free switch-off criterion (= switch-off criterion F) is based on the principle of the mean weight loss per unit of time. As soon as this drops below the preset value, the measurement is automatically ended.

  Press the «Method» key followed by the «Menu» key to open the Method menu.

F.SOC: NO

The free switch-off criterion is deactivated ("NO") as the factory setting.

F.SOC: YES



If you wish to set a free switch-off criterion, use the «Scroll up» and «Scroll down» keys to select "YES" and then press «Accept entry» to confirm.

WT.MG: 1



A flashing 1 will appear in the display. Then use the «Scroll up» and «Scroll down» keys to enter the weight loss (1 mg to 10 mg) in 1 mg increments. Press the «Accept entry» key to confirm your input.



Now enter the time in the flashing field. You can alter it in 5-second increments using the «Scroll up» and «Scroll down» keys. Enter any second value between 5 and 180. Press the «Accept entry» key to confirm your input.



Note: To perform a measurement with a free switch-off criterion, it must be defined in the Method menu. "F" must also be selected as the switch-off criterion (see Section 4.4).

5.4.2 Free factor (-MC)

The free factor **F.F.-MC** (0.500 to 2.000) for the moisture content can be defined in the Method menu. It is used to calculate a corrected final result (e.g. in order to compensate for systematic deviations from the reference result).



Press the «Method» key followed by the «Menu» key to open the Method menu.

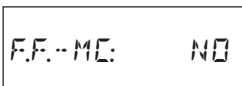

The free factor (-MC) is deactivated ("NO") as the factory setting.

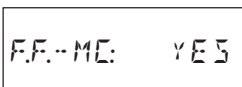

If you wish to set the free factor F.F.-MC, use the «Scroll up» and «Scroll down» keys to select "YES" and then press «Accept entry» to confirm.



Now enter the factor in the flashing field. You can alter it using the «Scroll up» and «Scroll down» keys. Enter any value between 0.500 and 2.000. Press the «Accept entry» key to confirm your input.

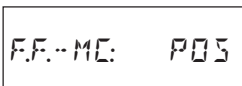

You can specify whether the factor has a positive ("POS") or negative ("NEG") sign.

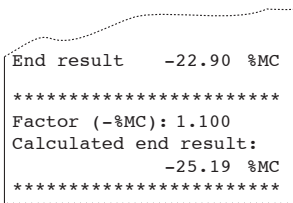

The final result is multiplied by the method-specific factor (0.500 to 2.000) in **%MC display mode** and highlighted on the printout as the calculated final result.

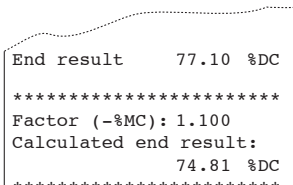

In **%DC display mode**, if you define a free factor (-MC), the final result %DC is converted by means of the formula below and highlighted on the printout.

$$\%DC = 100 + (\text{factor} \times \%MC)$$

Note: In **%AM**, **%AD** or **g** display mode, the final result is not converted.

5.4.3 Free factor (g)

The free factor **F.F.G** (1 to 100) can be defined regardless of the display mode setting - %MC, %DC, %AM, %AD or g.



Press the «Method» key followed by the «Menu» key to open the Method menu.

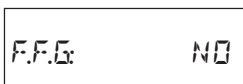

The free factor F.F.G is deactivated ("NO") as the factory setting.



If you wish to set the free factor **F.F.G**, use the «Scroll up» and «Scroll down» keys to select "YES" and then press «Accept entry» to confirm.

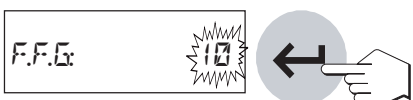

Now enter the factor in the flashing field. You can alter it using the «Scroll up» and «Scroll down» keys. Enter any value between 1 and 100. Press the «Accept entry» key to confirm your input.

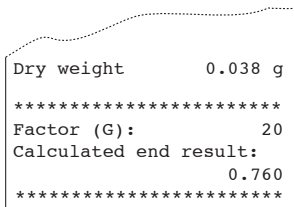

In %MC, %DC, %AM or %AD display mode, defining a **F.F.G** does not convert the final result.

5.4.4 Drying temperature to 200 °C without time limitation

In the standard setting of your moisture analyzer, drying temperatures of 160 °C to 200 °C are possible for only a limited period of time. After the temperature reaches this range, the instrument lowers the temperature back to 160 °C (this function is described in Section 4.3). For the sake of backward compatibility with previously developed methods, this time limitation continues to be the standard setting of the instrument.

However, if needed, the **temperature extension** setting is available to you in the Methods menu, and allows drying temperatures of up to 200 °C **without time limitation**.

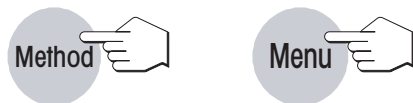

Press the «Method» key followed by the «Menu» key to open the Methods menu.

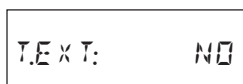

Temperature extension is deactivated ("NO") as the factory setting.



If you wish to activate the temperature extension, use the «Scroll up» and «Scroll down» keys to select "YES" and then press «Accept entry» to confirm.

Note:

- When working with temperatures over 180 °C, we recommend that you always wait 2 to 3 minutes between individual measurements, in order to ensure good reproducibility of the readings.

- A measurement cannot be started until the drying temperature is higher than the temperature in the measuring room. Otherwise, the message "Error 10" appears (Section 8.2).
- In the data printouts the temperature extension is documented as shown at left.

```

Switchoff mode    1
Standard drying
Drying temp.     185 °C
No temp. lowering
Disp.mode        g
Print interval   0:30 min

```

5.5 Printing out methods parameters

To ensure you do not lose your overview of the 10 methods, you can record the parameters of a particular method.

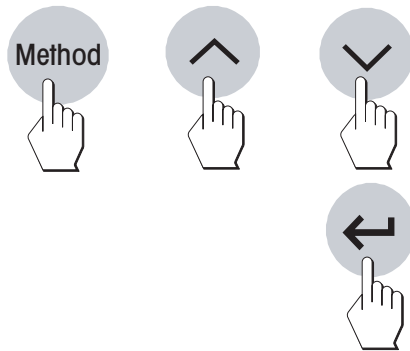

Call up the desired method (if not already active):

Press the «Method» key and select the method with the «Scroll up» and «Scroll down» keys.

Confirm your selection with the «Accept entry» key.



```

-----
-- METHODS-PARAMETERS --
-----
METTLER TOLEDO
Halogen MoistureAnalyzer
Type:                HG63
SNR:                 1234567890
SW:                  2.01

Method:
02                   CHECK
Switchoff mode      3
Gentle drying
Drying temp.        150 °C
Disp.mode           0...-100 %MC
Print interval      1:00 min
Target weight       2.500 g
Active              +/-10 %

-----30.06.03---15:50-----
-----

```

Press the «Print» key. A list of all parameters for the selected method is printed. Please consult Section 4 for the meaning of the individual parameters and settings. Depending on the settings, your record may look slightly different.

6 The menu (basic settings of the instrument)

6.1 Menu operation

In this Section you will learn how to use the menu to define the settings your instrument uses for operation. You will also find out how to adjust the integral balance and the heating module. The menu is a list of selection possibilities which you can use to preselect the **basic setting** of your instrument. The menu comprises various options (you will find an overview diagram of all menu options in Section 6.18). In addition to the settings (which are numbered for clarity), certain **functions** (e.g. balance adjustment and heating module adjustment) can also be performed. All menu settings are retained even in the event of a power failure.



Using the menu is simple:

Press the «Menu» key to call up the menu. The first menu option is balance adjustment (Section 6.2). All other menu items can be accessed by pressing the «Menu» or «Accept entry» key repeatedly.



You can use the «Scroll up» and «Scroll down» keys to switch between the selection possibilities within the current menu items and hence select the desired setting or execute the particular function.



Save changes

Once you have defined your setting in a menu option, press the «Accept entry» key. The setting will be saved and the next menu option opened.

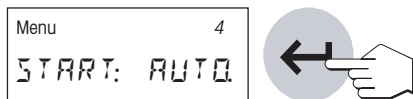

Do not save changes

If you close a menu option by pressing the «Reset» key, the changes made in the current menu option will not be saved.



Print menu settings

If your instrument is equipped with a built-in printer, you can record all menu settings. To do this simply press the «Menu» key followed by the «Print» key.

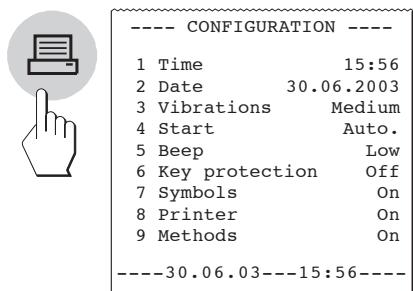

The following Sections will acquaint you with the individual menu items. The order corresponds exactly to that in the menu.

6.2 Adjusting the balance

In this menu item you can adjust the balance of your instrument. Consult Section 3.2 to learn when an adjustment is necessary. Before selecting the adjustment function, ensure that the sample pan is in position. Following a drying, you should wait at least 30 minutes before undertaking an adjustment.



The factory setting in this menu item is "NO" (no balance adjustment).

Note: The number above the word "NO" shows the number of adjustments performed to date.



If you wish to adjust the integral balance, select "YES" (using the «Scroll up» or «Scroll down» key).

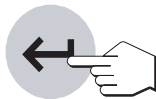

Press the «Accept entry» key to start the adjustment process. The sample chamber automatically opens.



The flashing display then prompts you to enter the adjustment weight (50 g).

Note: Ensure that your instrument is in a suitable location (see Section 2.2).

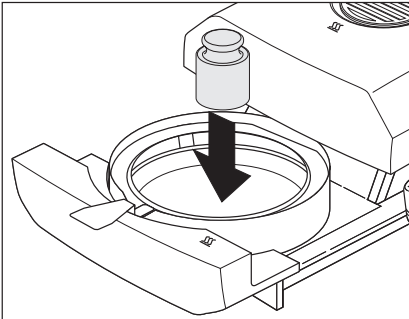

Place the requested adjustment weight in the middle of the sample pan. The weight is automatically recorded.

Note: The 50 g adjustment weight is available as optional equipment (see Section 9.8).

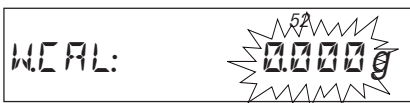

The instrument stores the determined weight value and the display prompts you to lift off the adjustment weight.

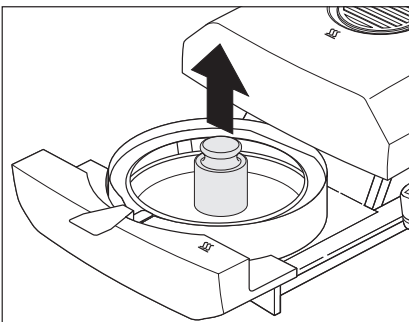

Remove the adjustment weight.

This concludes the adjustment of the balance and the instrument automatically quits the menu and returns to the standby mode. The Moisture Analyzer is now ready for further measurements.

```

A  -- BALANCE ADJUSTMENT --
B  30.06.2003      14:48

C  METTLER TOLEDO
   Halogen MoistureAnalyzer
D  Type:          HG63
E  SNR:          1234567890
F  SW:           2.01
G  Balance-Adjustment  159

H  Weight ID:
   .....
I  Weight:       50.000 g

J  Adjustment performed
   Signature:
   .....
   ----- END -----
    
```

If your instrument is equipped with the built-in printer and this is activated (see Section 6.15), on completion of the balance adjustment an adjustment record will be automatically printed out with the following data:

- A** Record title
- B** Date and Time of the record printout of the balance adjustment
- C** Manufacturer and Designation of the instrument
- D** Type of the instrument
- E** Serial number of the instrument
- F** Version number of the software
- G** Identification (consecutive number) of the balance adjustment, allows assignment of the measurement record to the appropriate adjustment record
- H** Field for entry of the number of the adjustment weight used
- I** Adjustment weight used
- J** Field for signature of the person who performed the balance adjustment

Please enter the number of the adjustment weight used, sign the record and store it in a safe place. This assures traceability, one of the basic requirements of every quality assurance system.

In the "W.CAL" menu you can print out the latest adjustment record at any time by pressing the «Print» key. Only one original copy (with signature field) can be printed, however.



6.3 Testing the balance

In this menu option you can test the balance on your instrument.

```

Menu
W.CAL:      NO
    
```

Checking balance adjustment

The factory setting in this menu item is "NO" (no balance adjustment).

```

Menu
W.CAL:      TEST
    
```

To test (calibrate) the integral balance, use the «Scroll up» or «Scroll down» keys to select "TEST".

Note: Ensure that your instrument is in a suitable location (see Section 2.2). Press the «Accept entry» key to start the test procedure. The sample chamber opens automatically.



```

W.CAL:      50000g
    
```

The flashing display then prompts you for the test weight.

Place the test weight on the balance. The rest of the procedure then continues automatically.



The display then shows you the recorded weight.
The test record is printed out automatically.

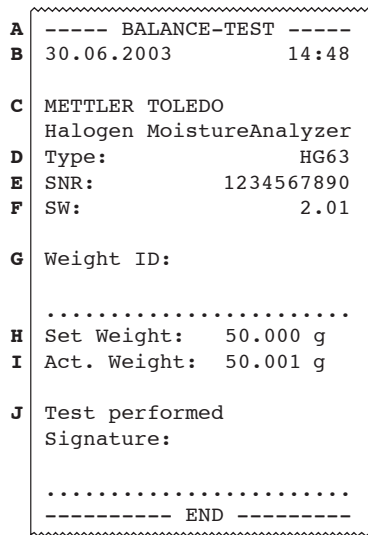

The balance test record contains the following information.

- A** Record title
- B** Date and Time of the record printout of the balance adjustment
- C** Manufacturer and Designation of the instrument
- D** Type of the instrument
- E** Serial number of the instrument
- F** Version number of the software
- G** Field for entry of the number of the adjustment weight used
- H** Test weight used (= set weight)
- I** Recorded weight (= actual weight)
- J** Field for signature of the person who performed the balance test



In the "W.CAL" menu you can print out the latest test record at any time by pressing the «Print» key. Only one original copy (with signature field) can be printed, however. The test record is only printed if the balance test was performed after the last balance adjustment.

6.4 Adjusting the heating module

In this menu item you can adjust the temperature control of the heating module. Consult Section 3.2 to learn when an adjustment of the heating module is necessary. We advise you to wait at least 30 minutes after a drying operation (or previous heating module adjustment) before performing the adjustment.

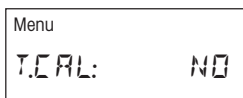

The factory setting in this menu item is "NO" (no heating module adjustment).

Note: The number above the word "NO" shows the number of adjustments performed to date.

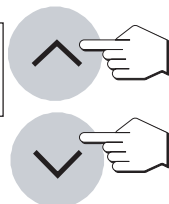
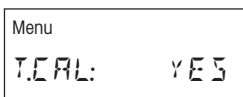

If you wish to adjust the heating module, select "YES" (using the «Scroll up» or «Scroll down» key).

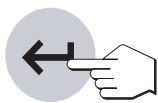

Press the «Accept entry» key to start the adjustment process. The sample chamber automatically opens and you are prompted to insert the temperature adjustment set.

Note: The temperature adjustment set is available as an accessory (see Section 9.8).

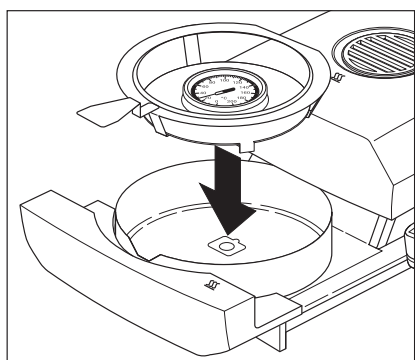

Remove the sample pan holder from the automatic sample chamber.

Place the temperature adjustment set (together with the sample pan handler) in the sample chamber.

Note: Ensure that your instrument is in a suitable location (see Section 2.2).



Press the «Start» key to initiate the adjustment process. The automatic sample chamber closes and the heating module adjustment starts.

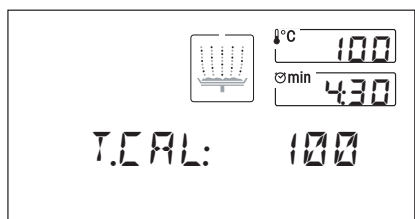

The heating module is heated to a temperature of 100 °C. You can follow this process in the temperature display. The instrument waits for 15 minutes until the temperature adjustment set is displaying the temperature correctly. At the end of this time a continuous audio signal sounds.

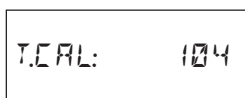

Read the temperature on the temperature adjustment set through the inspection window in the heating module and use the «Scroll up» and «Scroll down» keys to enter the value (NB: 1 graduation mark = 2 °C). After entering the value, press the «Accept entry» key. The temperature must be entered within 10 minutes of the audio signal sounding, otherwise the adjustment process will be terminated and an error message outputted.

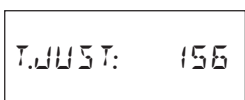

As this adjustment is a two-point adjustment (adjustment of the temperature is defined by two points, namely 100 °C and 160 °C), the heating module now heats to the second temperature (160 °C). Proceed exactly as you did for the first temperature. After you have confirmed your entry with the «Accept entry» key, the adjustment is at an end.

On completion of the adjustment, the sample chamber automatically opens and you can remove the sample pan handler with the temperature adjustment set.



Warning: On completion of the heating module adjustment, the instrument automatically quits the menu and returns to the standby mode. It is now ready for further measurements.

On completion of the heating module adjustment, the instrument automatically quits the menu and returns to the standby mode. It is now ready for further measurements.

The adjustment record is printed out automatically:

```

A - HEATING MODULE ADJUST-
B 30.06.2003      14:50

C METTLER TOLEDO
  Halogen MoistureAnalyzer
D Type:          HG63
E SNR:           1234567890
F SW:            2.01
G Heating module adj.  43

H Adjustment set ID:
.....
I Temperature 100°C: 101°C
J Temperature 160°C: 162°C

K Adjustement performed
  Signature:
.....
----- END -----

```

A Record title

B Date and Time of the record printout of the balance adjustment

C Manufacturer and Designation of the instrument

D Type of the instrument

E Serial number of the instrument

F Version number of the software

G Identification (consecutive number) of the heating module adjustment, allows assignment of the measurement record to the appropriate adjustment record

H Field for entry of the number of the temperature adjustment set used (number is printed on the set)

I Set and actual temperature for the first adjustment point

J Set and actual temperature for the second adjustment point

K Field for signature of the person who performed the heating module adjustment

Enter the number of the temperature adjustment set, sign the record and store it in a safe place. This assures traceability, one of the basic requirements of every quality assurance system.

In the "T.CAL" menu you can print out the latest adjustment record at any time by pressing the «Print» key. Only one original copy (with signature field) can be printed, however.



6.5 Testing the heating module

In this menu option you can test the temperature control on the heating module.

```

Menu
T.CAL:  NO

```

Check the heating module adjustment with TEST

The factory setting in this menu item is "NO" (no heating module adjustment).

```

Menu
T.CAL:  TEST

```



To check the last heating module adjustment at 100 °C and 160 °C, use the «Scroll up» or «Scroll down» keys to select "TEST". Press the «Accept entry» key to confirm your selection.

T.TEST:



Press the «Accept entry» key to start the test procedure. The sample chamber opens automatically and you are prompted to insert the temperature adjustment set.

Note: Ensure that your instrument is in a suitable location (see Section 2.2). With the HA-TCC temperature adjustment set, the HG63 can maintain a tolerance of +/- 3°C.



Press the «Start» key to initiate the test procedure. The sample chamber closes and the test for the two-point heating module adjustment begins. Now proceed as for the standard two-point heating module adjustment.

The test record is printed out automatically.

The heating module test record contains the following information.

```

A --- DRYER UNIT TEST ---
B 30.06.2003      14:48
C METTLER TOLEDO
  Halogen MoistureAnalyzer
D Type:          HG63
E SNR:           1234567890
F SW:            2.01
G Adjustment set ID:
.....
H Set Temperature: 100 °C
I Act. Temperature: 101 °C
J Set Temperature: 160 °C
K Act. Temperature: 161 °C
L Test performed
  Signature:
.....
----- END -----
    
```

- A** Record title
- B** Date and Time of the record printout of the balance adjustment
- C** Manufacturer and Designation of the instrument
- D** Type of the instrument
- E** Serial number of the instrument
- F** Version number of the software
- G** Field for entry of the number of the temperature adjustment set used (number is printed on the set)
- H** Set temperature (first temperature) for the test adjustment
- I** Actual temperature (first temperature) for the test adjustment
- J** Set temperature (second temperature) for the test adjustment
- K** Actual temperature (second temperature) for the test adjustment
- L** Field for signature of the person who performed the heating module test



In the "T.CAL" menu you can print out the latest test record at any time by pressing the «Print» key. Only one original copy (with signature field) can be printed, however. The test record is only printed subsequently if the heating module test was performed after the last heating module adjustment.

6.6 Resetting to the factory settings

In this menu item you have the possibility to reset the basic settings of the instrument to the factory setting.



Warning! With the exception of the time, date and dialog language, all individual settings (incl. the method memory) you have made in the menu will be lost and replaced by the factory settings!

```
Menu
FCT.SET:  NO
```



The factory setting in this menu item is "NO". If you really wish to delete your individual menu settings, select "YES" and confirm this with the «Accept entry» key.

```
Menu
FCT.SET:  YES
```

```
Menu
  ABORT?
```



For reasons of safety, you are again asked if you really wish to delete your data. You can abort the procedure at this point or delete the data, i.e. reset to the factory settings. Confirm your selection with the «Accept entry» key.

```
Menu
  SET?
```

6.7 Clearing the method memory

The method memory contains the individual settings for your measurements (switch-off criterion, display mode, print interval, etc.). This menu item allows the method memory to be cleared. Your settings will be replaced by the factory settings.



Warning! If the method memory is cleared, you will lose all individual settings with the exception of the settings in the menu!

```
Menu
MCLR:    NO
```



The factory setting in this menu item is "NO". If you really wish to clear the method memory, select "YES" and confirm this with the «Accept entry» key.

```
Menu
MCLR:    YES
```

```
  ABORT?
```



For reasons of safety, you are again asked whether you really wish to clear the method memory. You can abort the procedure at this point or clear the memory. Confirm your selection with the «Accept entry» key.

```
  CLEAR?
```

6.8 Setting the time

In this menu item you enter the current time. This is necessary when putting your instrument into operation for the first time and for possible corrections (e.g. changeover from summer to winter time).

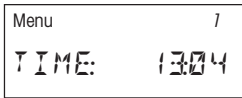

Set the time with the «Scroll up» and «Scroll down» keys (Range 00:00–23:59).

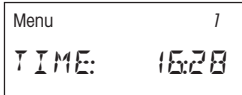

Confirm your setting with the «Accept entry» key and the instrument stores the time.

6.9 Entering the date

In this menu item you enter the current date. This is necessary when putting the instrument into operation for the first time and for possible corrections.

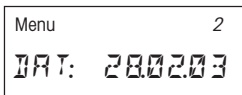

Set the date with the «Scroll up» and «Scroll down» keys in the format “Day – Month – Year” (DD.MM.YY). Confirm your entry with the «Accept entry» key and your instrument stores the date.



Note: If US English is used as the dialog language, the entry has the format “Month – Day – Year” (MM/DD/YY).

6.10 Setting the vibration adapter

You can use the vibration adapter to match your instrument to the ambient conditions at its location.

The following settings are available:

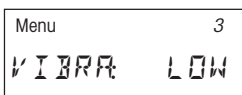

Setting for very stable ambient conditions. The instrument operates quickly but is sensitive to vibrations.



Setting for normal ambient conditions. This is the **factory setting**.

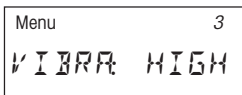

Setting for unstable ambient conditions. The instrument operates more slowly but is less sensitive to vibrations.



Select the appropriate setting and confirm your selection with the «Accept entry» key.

6.11 Selecting operating mode of the automatic sample chamber

In this menu item you can choose whether the automatic sample chamber should operate automatically or manually. Your instrument is set in the factory to the automatic operating mode. We advise you to use the manual operating mode for samples which contain readily volatile substances. In contrast to the automatic operating mode, in the manual operating mode the sample chamber does not automatically close when the «Start» key is pressed. However, the initial weight (wet weight) important for the determination of the moisture content is recorded. In the manual operating mode you have time for further preparation of the sample (e.g. mixing with quartz sand or even distribution of the sample) while weight losses due to evaporation during the preparation time are measured from the outset. As soon as the sample is ready for drying, press the key «Open/close auto sample chamber». The automatic sample chamber closes and drying starts. In the manual operating mode you yourself can open the sample chamber during a drying operation. In contrast to the automatic mode, drying will not be stopped but simply interrupted until the automatic sample chamber is closed again.

Menu 4
START: AUTO

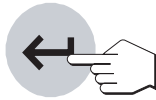

The factory setting in this menu item is "AUTO." (automatic operating mode). If you wish to switch to the manual operating mode, select "MAN." and confirm this with the «Accept entry» key.

Menu 4
START: MAN

6.12 Audio signal

Many processes are signalled by an audio signal (e.g. end of drying, entries, error messages, etc.). In this menu item you can select whether the audio signal should be loud, soft or switched off.

The following settings are available:

Menu 5
BEEP: OFF

No audio signal

Menu 5
BEEP: LOW

Soft signal (**Factory setting**)

Menu 5
BEEP: HIGH



Loud signal

Select the desired setting and confirm with the «Accept entry» key.



Note: The alarm clock symbol in the display indicates that an audio signal has been activated in the menu.

6.13 Protecting your settings against change

You can protect the settings of your methods parameters (e.g. switch-off criterion, drying temperature, etc., see Section 4) and the settings in the Methods menu (Section 5.4) against change by locking the appropriate keys for entries.

Menu 6
KEY.PROT: OFF

The instrument is set in the factory to allow the parameters to be changed ("PROT: OFF").

Menu 6
KEY.PROT: ON



If you wish to protect the settings against change, selection "PROT: ON" and confirm this with the «Accept entry» key.



The display shows the padlock symbol and the following settings can then no longer be changed:

- Switch-off criterion
- Drying program
- Display mode
- Print interval
- Drying temperature
- Drying time
- Target weight of the weighing-in aid
- All settings in the Methods menu (Section 5.4)

If you press one of the locked keys, an audio signal and an error message (see Section 8.2) draw your attention to the nonavailability of the corresponding function.

6.14 Superimposing or removing the function symbols

In this menu item you can select whether the function symbols should always be visible or only when needed. In routine operation, the display is easier to survey if the symbols are faded out.

Menu 7
SYMBOL: ON

In the factory the symbols are switched on ("ON").

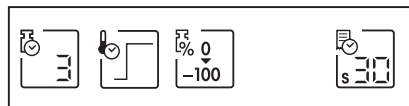

Menu 7
SYMBOL: OFF



If you wish to switch off the symbols, select "OFF" and confirm this with the «Accept entry» key.

Note: If you switch off the function keys, they will be displayed for around 30 seconds when the instrument is switched on and then faded out. If one of the function keys is pressed, the function symbols will be shown immediately and then faded out again 30 seconds after a function key has last been pressed.

6.15 Switching the printer on or off

In this menu item you can switch the built-in printer on or off.

Menu	8
PRINT:	ON

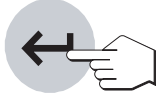

In the factory this item is switched on ("ON").

Menu	8
PRINT:	OFF

If you wish to switch the printer off, select "OFF" and confirm this with the «Accept entry» key.

6.16 Switching the method option on or off

If you do not wish to work with methods (see Section 5), you can switch off the method options in this menu item. This simplifies operation of the instrument if you work only with one type of sample and consequently do not require the possibilities offered by the methods.

Menu	9
METH	ON

In the factory the method option is switched on ("METH: ON").

Menu	9
METH	OFF

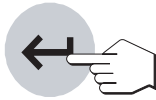

To switch the method option off, select "METH: OFF" MET: OFF and confirm this with the «Accept entry» key. You now no longer have the possibilities of the method option available.

6.17 Selecting the dialog language

In this menu item you specify the dialog language.

Menu
DEUTSCH



Menu
FRANCAIS

Menu
ITALIANO

Menu
ESPAÑOL

Menu
RUSSIAN

Menu
ENGLISH EU

Menu
ENGLISH US

Select the desired dialog language and then confirm your entry with the «Accept entry» key.

The following languages are available:



- German (“Deutsch”)
- French (“Français”)
- Italian (“Italiano”)
- Spanish (“Español”)
- Russian (“Russian”)
- British English (“English EU”)
- American English (“English US”)

Note: If you select American English (“English US”) as the dialog language, the date format is changed and appears on all records in the American notation (month/day/year).

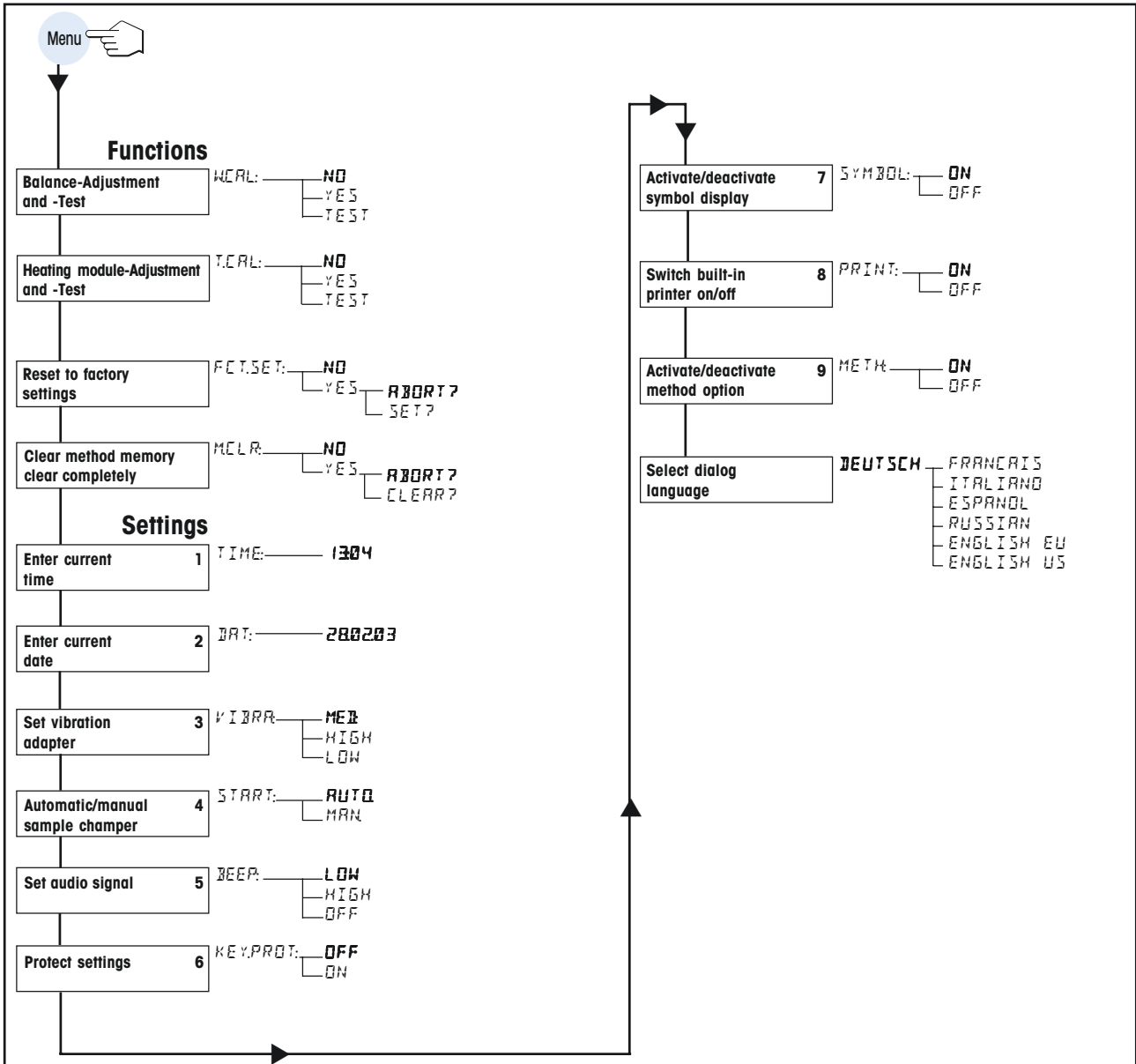
6.18 Menu overview HG63

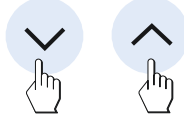

Selecting the setting within a menu item:

 <p>Quits the menu without saving the last menu item you changed</p>	 <p>Calls up the next menu item</p>
 <p>Saves the menu item and skips to the next menu item</p>	 <p>Select settings</p>

For information on the separate Method menu, please refer to Section 5.4.

7 Servicing and replacing individual parts

In this Section you will learn how to keep your Moisture Analyzer in good condition and how to replace expendable parts. You also find information on how to check the printer and change the printer paper and ribbon.

7.1 Cleaning

To obtain precise measurement results, we advise you to clean the temperature sensor and the protective glass of the heating modules at regular intervals. Please note the following directions for cleaning your instrument:

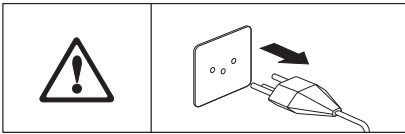

Disconnect the instrument from the power supply before cleaning.

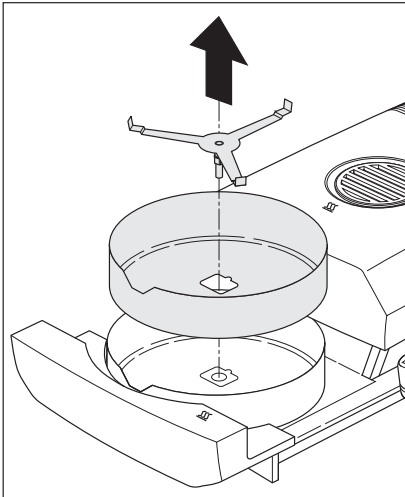

Open the automatic sample chamber by pulling it out.

Remove the draft shield element and the sample pan holder before cleaning.

Use a lint-free cloth for cleaning.

Clean the exterior of the instrument and the drying compartment with a mild cleaning agent. Although the housing is extremely rugged and resistant to solvents, never use abrasive cleaning agents or solvents!

Ensure that no liquid enters the interior of the instrument.

To clean the temperature sensor and the protective glass of the heating module, you should first open the heating module as described in Section 7.6.

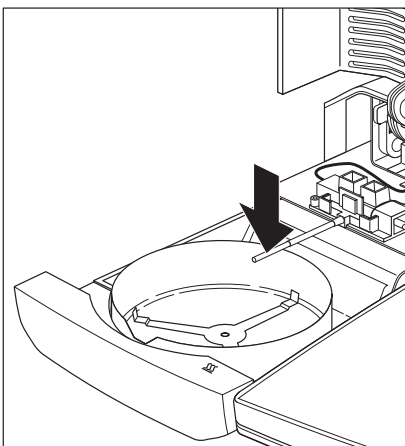

Carefully remove any deposits from the black temperature sensor.

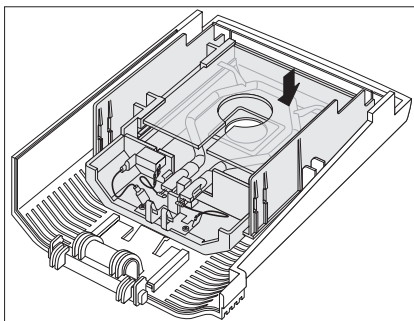

To clean the protective glass of the heating module, dismantle the heating module (see Section 7.6), place it on a flat work surface and clean the protective glass with a commercial glass cleaner.

The air inlet of the fan is located at the rear of the instrument and its exterior should be cleaned from time to time to free it from any dust deposits.

After the temperature sensor and/or the protective glass have been cleaned, we recommend adjusting the heating module (Section 6.4).

7.2 Changing the printer paper and ribbon

Apart from the need to replace the printer paper and ribbon on occasion, the built-in printer requires no maintenance.

Changing the printer paper

The printer paper is changed as follows:

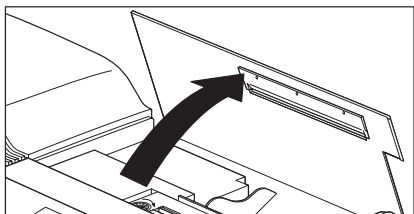

Open the cover of the built-in printer.

Pull any remaining paper upwards out of the printing unit.

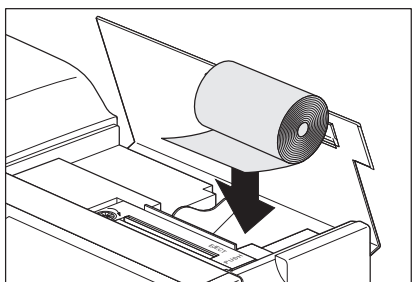

Insert a new roll of paper in the paper compartment and feed the paper horizontally through the slot at the back of the printing unit.



Press the «Paper feed» key until the leading edge of the paper exits the printing unit at the top.

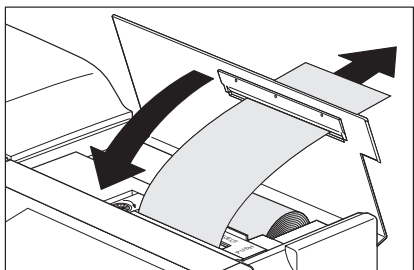

Lead the paper through the slot in the cover of the built-in printer and close the cover.

Replacing the ribbon

When the print quality deteriorates, replace the ribbon as follows:

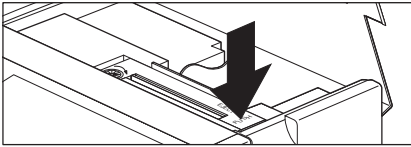

Open the cover of the built-in printer and press the projection marked "PUSH" on the right of the ribbon cassette.

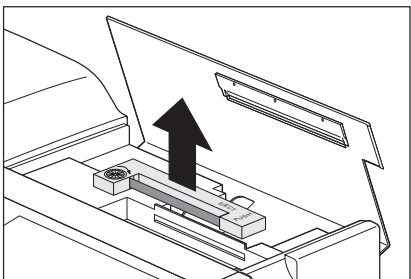

Pull the ribbon cassette up and out of the instrument and insert the new cassette. Thread the paper between the ribbon and the cassette. Press the cassette down as far as it will go until you hear it click into place.

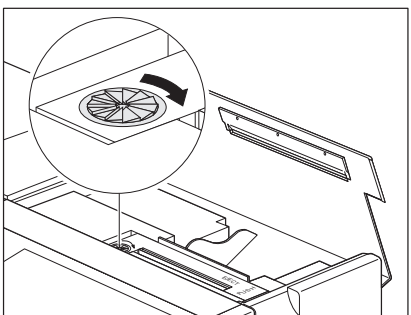

Tension the ribbon by turning the small wheel on the left of the cassette in the direction shown by the arrow. After you have tensioned the ribbon, close the cover of the printer.

Used ribbons must be disposed of in accordance with applicable customer and national regulations.

7.3 Replacing the power line fuses

If the display of your instrument remains "dark" after switching on, in all probability the power line fuses of the instrument are blown.

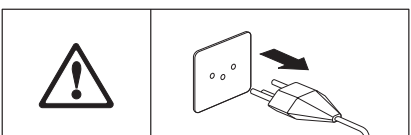

To change the fuses, proceed as follows:

Disconnect the instrument from the power supply.

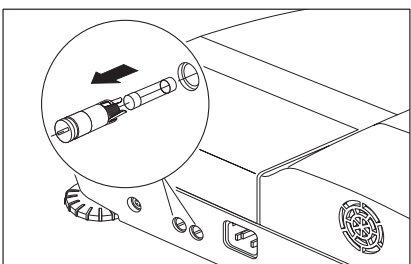

The two power line fuses (for neutral and phase) are located at the rear of the instrument. Turn the two fuse holders with a screwdriver to the left and pull the fuse holders out of the instrument.

Check the condition of **both** fuses. Replace blown fuses by those of the same type with the same rated value (5 x 20 mm, T6, 3H 250 V).



The use of fuses of a different type or with different values as well as the bridging of fuses is not allowed and can hazard your safety and lead to instrument damage!

7.4 Printer test

Your instrument has a function to check the proper functioning of the built-in printer.

Ensure that the instrument is switched off.

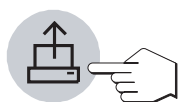

Press and hold the «Paper feed» key while simultaneously switching the instrument on with the «On/Off» key. The printer prints out its complete character set.



To stop the test, switch the instrument off with the «On/Off» key.

7.5 Installing the built-in printer

If your instrument is not already fitted with a built-in printer, you can order a printer as an option and retrofit it at any time. You can also change the built-in printer yourself without any problems should this be necessary. The procedure for installing the built-in printer is described in the **11780558** you received with the printer.

7.6 Dismantling and replacing the heating module

If a fault arises, the complete heating module can be replaced. We also advise you to open or dismantle the heating module to clean the protective glass of the heating module (see Section 7.1).

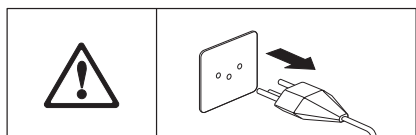

Disconnect the instrument from the power supply and be sure to allow the heating module to cool down for 10 minutes before you start the work!

The heating module is released by withdrawing the automatic sample chamber 2–3 cm.

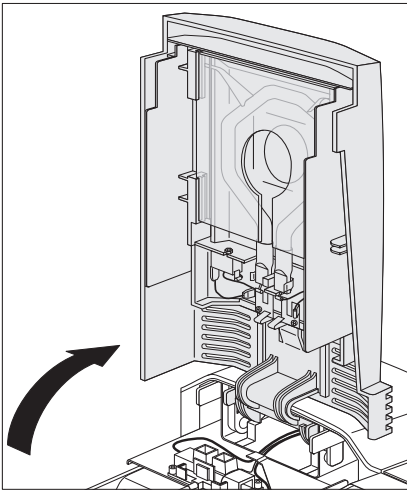

Swing the heating module upward.

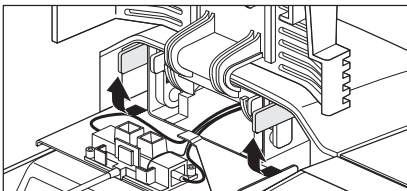

Disengage the hinge of the heating module by turning the two yellow levers 90 °C forward.

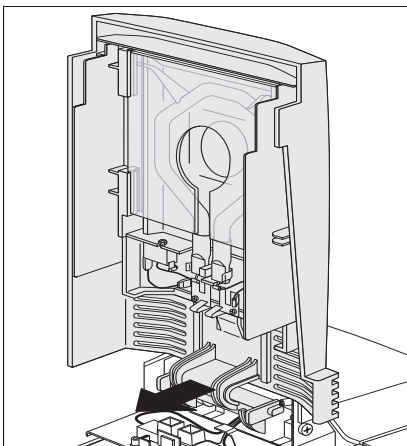

Remove the heating module (pull forward).

Install the (new or cleaned) heating module in the instrument and lock the hinge with the two yellow levers.

After a heating modules has been cleaned or replaced, we recommend re-adjusting the heating module of your Halogen Moisture Analyzer (Section 6.4).

Defective parts must be disposed of in accordance with applicable customer and national regulations.

8 If problems arise on occasion

In this Section you will learn how errors can appear during operation of your Moisture Analyzer and how you can rectify these errors.

8.1 Notes on the error messages

Your instrument distinguishes between the three different types of errors explained below.

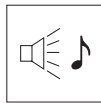

Input errors (key not active or can not be pressed in current operating status) are reported by your instrument with a short audio signal (if activated in the menu) without an error message in the display.

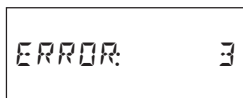
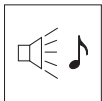

An **application error** occurs when the instrument can not perform a procedure or a corrective action is necessary as the limits of a value range have been violated or because a general operating error exists. Application errors are reported by your instrument with an audio signal. Further, the message "ERROR" appears in the display followed by the error number. You will find a list of all application errors in the next Section.

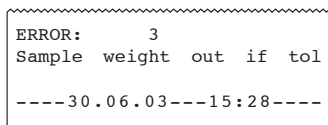

If your instrument is equipped with a built-in printer, you can print the error message **in clear text** with the «Print» key.

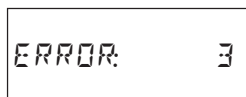

Before you can continue working, you must delete the error message with the «Reset» key.

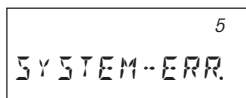



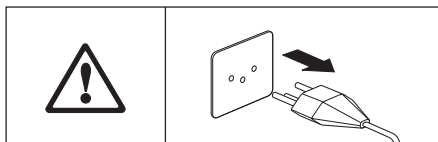

System errors indicate that a program or hardware error exists. The message "SYSTEM-ERR." appears in the display and the error number is shown in the top right corner. In such a case, disconnect the instrument from the power supply. Should the error reappear after reconnection to the power supply, contact your METTLER TOLEDO dealer to arrange an appointment for diagnosis and repair. Note the error number in order to facilitate the work of the service engineer.

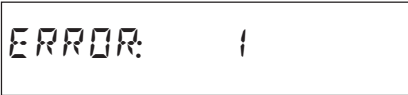
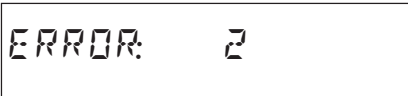

8.2 Meaning of the error messages

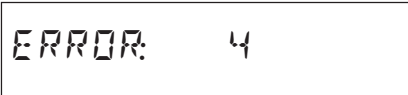
In this Section you will find all error messages which appear in the display, the text of the error record on the printer, the reason for the error message and directions on how to rectify the error.

	<p>Display: Error: 1 Printout: Weighing result unstable Cause: No stability during taring or adjustment Remedy: Ensure stable ambient conditions and an optimum location. Also take care that no part of the sample or the sample pan touch the draft shield element or the sample pan holder. Highly volatile substances in the sample also prevent a stable weighing result being detected.</p>
	<p>Display: Error: 2 Printout: Wrong calibration weight Cause: No or wrong adjustment weight loaded Remedy: Load required adjustment weight</p>
	<p>Display: Error: 3 Printout: Sample weight outside limits Cause: Sample weight below 100 mg or outside the set limits with the weighing-in aid active (Section 4.7). Remedy: Weigh in a sample of at least 100 mg, adjust the sample weight so that it is within the set limits or deactivate the weighing-in aid.</p>
	<p>Display: Error: 4 Printout: Missing tare weight Cause: Sample vessel has not been tared Remedy: Tare sample vessel</p>
	<p>Display: Error: 5 Printout: Entry inadmissible Cause: Lower/ upper limit of input range violated Remedy: Enter value in valid range</p>

ERROR: 6	<p>Display: Error: 6</p> <p>Printout: Not activated in menu</p> <p>Cause: Keypad has been locked in menu, printer deactivated in menu</p> <p>Remedy: Remove keypad locking, printer in menu</p>
ERROR: 7	<p>Display: Error: 7</p> <p>Printout: Timer not activated</p> <p>Cause: The selected switch-off criterion does not allow entry of a time</p> <p>Remedy: Select "Timed switch-off" as switch-off criterion</p>
ERROR: 8	<p>Display: Error: 8</p> <p>Printout: Entry missing</p> <p>Cause: In the heating module adjustment, the wait time of 10 minutes for entry of the temperature value has been exceeded</p> <p>Remedy: Repeat heating module adjustment and enter temperature values before elapse of the wait time</p>
ERROR: 9	<p>Display: Error: 9</p> <p>Printout: Function error</p> <p>Cause: Undefined condition</p> <p>Remedy: Press «Reset» key or briefly switch instrument off then on again with the «On/Off» key. If this error appears in the calibration, please contact your METTLER TOLEDO dealer</p>
ERROR: 10	<p>Display: Error: 10</p> <p>Printout: Temperature > Start-Temp.</p> <p>Cause: Sample chamber has not cooled down sufficiently.</p> <p>Remedy: Allow the instrument to cool down to the starting temperature</p>
.	<p>Display: </p> <p>Cause: Underload</p> <p>Remedy: Load the sample pan holder</p>
.	<p>Display: </p> <p>Cause: Overload</p> <p>Remedy: Decrease the weight of your sample</p>



Display: RAM LOST

Cause: The installed battery is discharged (the equipment was disconnected from the power supply for a longer period) or the instrument is faulty

Remedy: Charge battery (connect instrument to the power supply for 5 hours) and then reenter all settings. If the error reappears, contact your METTLER TOLEDO dealer.

8.3 What if...?

... the display remains "dark" after switching on?

- no line voltage
- power cable not connected
- blown power line fuses
- instrument faulty

Ensure that the instrument is connected to the power supply and that power supply is actually supplied. Check the power line fuses of the instrument and replace if necessary (see Section 7.3). If the instrument still refuses to function, contact your METTLER TOLEDO dealer.

... after switching on "0.000" flashes in the display?

The sample pan holder is not installed. Install the sample pan holder.

... the function symbols disappear from the display after a certain time

You have deactivated the symbols in the menu (see Section 6.14).

... the symbol of the stability detector is continuously lit up immediately after the start?

As soon as the symbol of the stability detector fades, the weighing result is stable and is accepted as a "wet weight". If the symbol does not fade, your instrument is probably at an unsuitable location (vibrations, shocks, powerful drafts, etc.). Seek a more suitable location.

Samples containing readily volatile substances may never reach stability owing to continuous evaporation. In this case, you must select manual operation for the automatic sample chamber (see Section 6.11).

... the built-in printer does not print?

Ensure that the printer is activated in the menu (see Section 6.15) and that the ribbon and paper are correctly installed. If the printer still refuses to print, perform a printer test (see Section 7.4). If the test is unsuccessful, contact your METTLER TOLEDO dealer.

... no drying time can be entered?

Entry of the drying time is possible only if you have selected the switch-off criterion "Timed switch-off", with all other switch-off criteria this input possibility is not available (see Section 4.4). If you attempt to enter a drying time, the instrument reports "Error: 7" (see Section 8.2).

... certain keys are inactive?

You have protected the parameters (switch-off criterion, print interval, etc.) in the menu against change (see Section 6.13). If you attempt to change a parameter, the instrument reports "Error: 6" (see Section 8.2).

... an error message appears when I press certain keys?

You have entered an illegal value, see Error messages (see Section 8.2)

... the measurement takes too long?

You have selected an unsuitable switch-off criterion. The suitable switch-off criterion is simple to determine by a test measurement. You will find information on how to perform a test measurement in Sections 4.4 and 4.11.

An excessive amount of sample can also be the cause of slow drying, likewise samples which tend to form a skin which hinders vaporization.

Perform experiment at higher temperature.

... the weighing-in aid is not visible?

The weighing-in aid is available only if you have activated (see Section 4.7).

... the automatic sample chamber does not close after pressing «Start»?

You have selected the manual operating mode in the menu (see Section 6.11).

... no methods are available?

You have deactivated the method option in the menu (see Section 6.16).

... the instrument does not heat following the start?

The dryer unit is overheated and the thermal overload protection has responded. The instrument is equipped with thermal overload protection (bimetallic sensor) which switches off the heating tube if overheating occurs. If this happens, the device must be reset. To do this, proceed as follows:

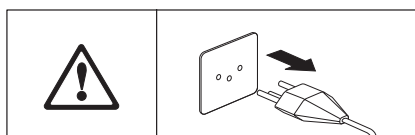

Disconnect the instrument from the power supply and be sure to allow the heating module to cool down for 10 minutes before you start the work.

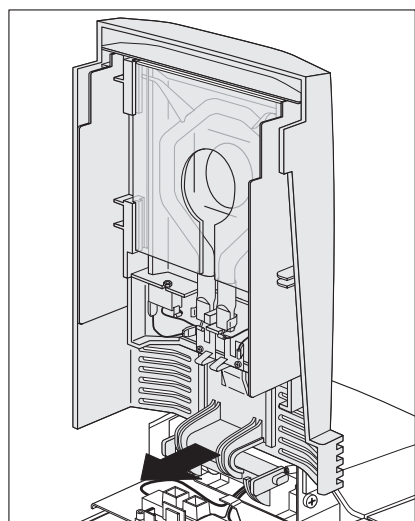

The heating module is released by withdrawing the automatic sample chamber 2-3 cm.

Swing the heating module upward.

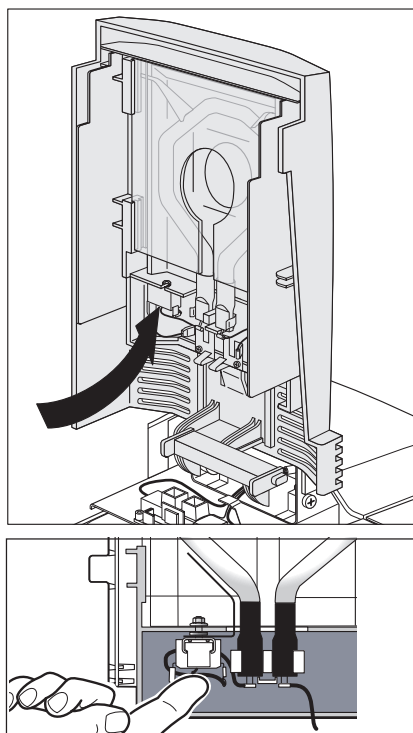

The thermal overload protection is reset by pressing the rear part of the white temperature switch.

The Analyzer can be restarted after closing the cover and connecting the instrument to the power supply.

Note: If this is not possible, there may be a fault (e.g. a faulty halogen heating module). In such a case, contact your METTLER TOLEDO dealer.

After the temperature switch is reset or a heating module replaced (Section 7.6) we recommend that you readjust the heating module of your Halogen Moisture Analyzer (Section 6.4).

... the measurement results are not repeatable?

- The samples are not homogeneous, i.e. they have different compositions. The more inhomogeneous a sample, the larger the amount of sample needed to obtain a repeatable result.
- You have selected a drying time that is too short. Extend the drying time or select a suitable switch-off criterion "Weight loss per unit of time".
- The sample does not become completely dry (e.g. owing to skin formation). Dry the sample with the aid of glass fiber filters (Section 3.3).
- You have selected a temperature that is too high and the sample has oxidized. Lower the drying temperature.
- The sample boils and the splashed drops continuously change the weight. Lower the drying temperature.
- You are working with an extremely high-volatile sample, but you did not select the manual start. Select manual start for such samples.
- The sample was not prepared in the best possible way. Check that the samples are being stored properly, review the work process, make sure the samples are distributed evenly over the entire sample pan, etc.
- Insufficient heating power as the protective glass is dirty. Clean the protective glass (Section 7.1).
- The temperature sensor is contaminated or faulty. Clean the temperature sensor (see Section 7.1) or have it replaced by a service engineer.
- The support on which the instrument is standing is not sufficiently stable. Use a stable support.
- The instrument is not stable on its 4 feet.
- The surroundings are very unstable (vibrations etc.).

9 Further useful information

9.1 Notes on interpretation of the measurement results and the ideal sample weight

The accuracy of the measurement results depends on the wet weight and the original moisture of the sample. The relative accuracy of the measurement result improves with increasing wet weight. While the moisture of the sample is fixed, the weight of the sample can frequently be determined by the user. However, with increasing weight the drying process is lengthened. **We thus advise you to select the weight of your sample to obtain the repeatability you require.** You can use the following table to determine the ideal weight for your sample. The table does not include the scatter due to the sample and its preparation.

An example will suffice: A result with a repeatability of $\pm 0.1\%$ is expected. As the following table shows, your sample should have a minimum weight of 2 grams.

Repeatability of the result	Minimum sample weight
$\pm 0.02\%$	10 g
$\pm 0.05\%$	4 g
$\pm 0.1\%$	2 g
$\pm 0.2\%$	1 g

9.2 LocalCAN universal interface

Your Moisture Analyzer is fitted with a modern LocalCAN universal interface. This universal interface allows your instrument to interchange data with a computer or a control system. METTLER TOLEDO LC-P43 and LC-P45 printers can also be operated via this interface. The content and format of the printouts are the same as those produced by the optional built-in printer HA-P43.

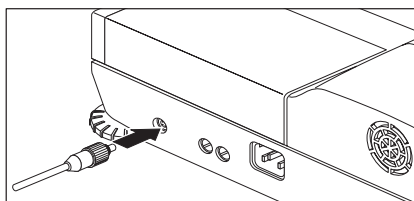

Devices (e.g. a computer) with an RS232 serial interface (with a DB9 or DB25 connector of the type usually found with PCs and laptops/notebooks) can be attached with the optional interface cables (LC-RS9 or LC-RS25, see Section 9.8).

For interface commands please refer to the "Reference Manual METTLER TOLEDO Standard Interface Command Set" 1 1780559, available from your METTLER TOLEDO dealer or download from the Internet (www.mt.com/moisture). More Information please find in the Section 9.7.

Data of the LocalCAN universal interface

- Cable length between two devices maximum 10 m
- Total of cable lengths of all attached devices maximum 15 m

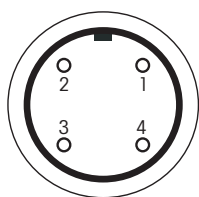
SPin assignment

Pin No.	Signal
1	negative signal line (-CAN)
2	positive signal line (+CAN)
3	plus pin of supply (V CAN) for peripherals
4	minus pin of supply (0 V) for peripherals

9.3 Application brochure

The application brochure for moisture determination from METTLER TOLEDO (order number: 11795011) contains a great deal of useful information for optimum utilization of your Moisture Analyzer. To order your personal copy, please contact your METTLER TOLEDO dealer.

Example methods and applications can be found at www.mt.com/moisture.



Moisture determination applications must be optimized and validated by the user according to local regulations. Application-specific data provided by METTLER TOLEDO is intended for guidance only.

9.4 Switch-off criterion “Weight loss per unit of time”

With the switch-off criterion “Weight loss per unit of time”, drying is automatically ended as soon as the **mean** weight loss (Δg in mg) per unit of time (Δt in seconds) drops below a preset value. 5 levels are preprogrammed in the factory each with a fixed weight loss per unit of time.

Further, a “Free switch-off criterion” allows you to define the weight loss per unit of time yourself.

The following applies to the individually selectable levels:

	Δg in mg	Δt in seconds
Switch-off criterion 1	1 mg	10 seconds
Switch-off criterion 2	1 mg	20 seconds
Switch-off criterion 3	1 mg	50 seconds
Switch-off criterion 4	1 mg	90 seconds
Switch-off criterion 5	1 mg	140 seconds
Switch-off criterion “F” (free)	1 mg to 10 mg	5 seconds to 3 minutes

The graph below exemplifies the mode of operation of the switch-off operation (not to scale).

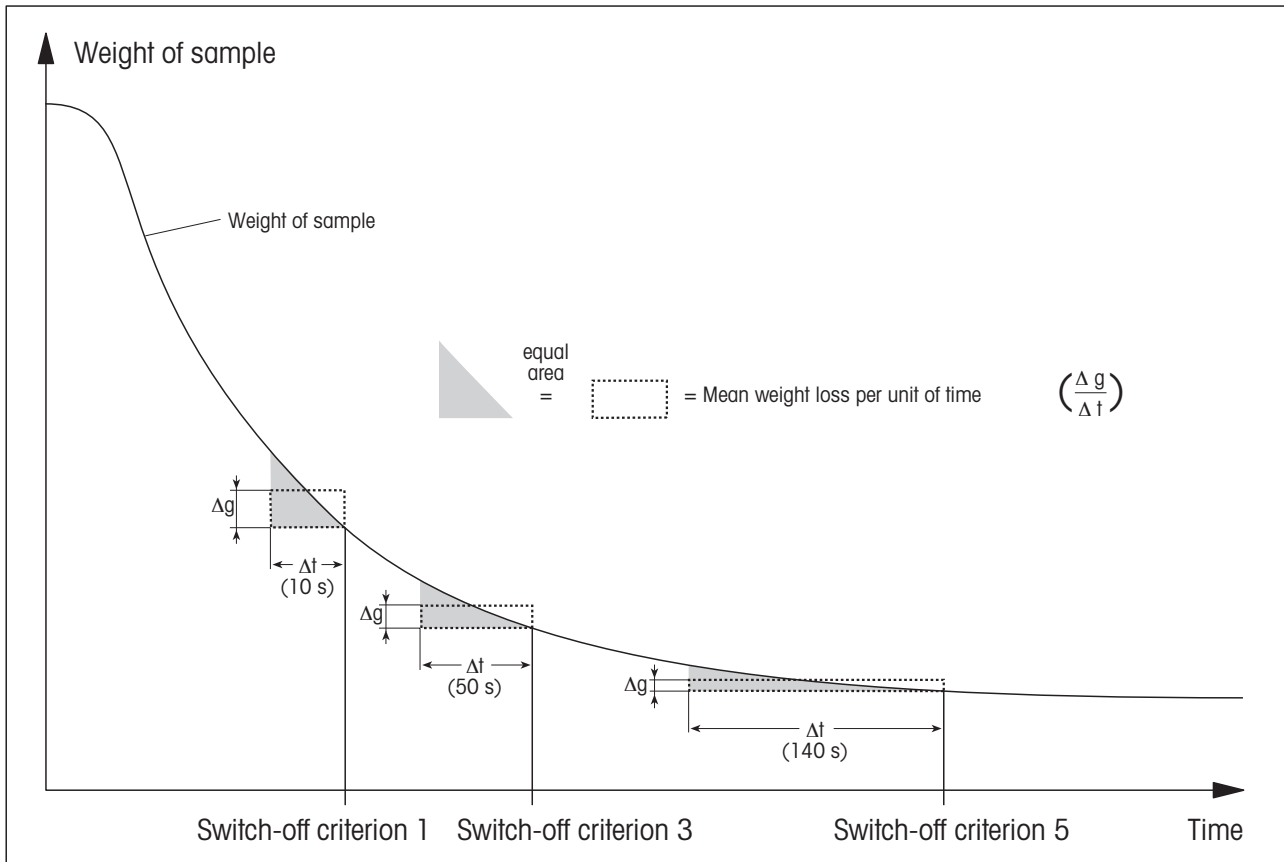

Key:

Switch-off criterion 1 (rapid availability of the result, suitable for determination of a trend)

Switch-off criterion 3

Switch-off criterion 5 (suitable for precision measurement)

9.5 Comments on certified version

Approval of the built-in balance is to EN45501 (OIML R76) requirements. When the heating module is switched off, the balance meets the applicable requirements of accuracy class 1. The metrological data are given on the certification plate (rear panel of instrument).

Adjustment of the built-in balance

Before adjustment of the balance, a wait time of 15 min. (following completion of the last heating cycle) assures compliance with the calibration tolerance limits following EN45501 (OIML R76).

9.6 Technical data

Please note that the Moisture Analyzer will undergo continuous further development in the interest of the users. METTLER TOLEDO thus reserves the right to change all technical data at any time and without prior notification.

TDryer

Heating module:	Halogen ring-shaped radiator
Temperature range:	40–200 °C
Temperature step:	1 °C
Heating module adjustment:	with temperature adjustment set HA-TC or HA-TCC
Heating module test:	100 °C / 160 °C

Balance

Minimum sample weight:	0.1 g
Maximum sample weight: ¹⁾	61 g
Balance adjustment:	with external weight, 50 g ± 0.1 mg
Weighing test:	50 g
Units:	g, % moisture content, % dry content, ATRO moisture content, ATRO dry content
Stability detector:	with symbol in display
Readability of the balance:	1 mg
Readability of the result:	0.01%
Repeatability (sd) with 1 g sample: ²⁾	0.2%
Repeatability (sd) with 10 g sample: ²⁾	0.02%

Data

Time, date:	system clock, fail safe
Drying time:	manual, 30 seconds to 480 minutes
Operational settings:	read-only memory, fail safe
Switch-off criteria:	5 levels, manual, timed, test, free
Method memories (fail safe):	10
Drying programs:	Standard- or Fast drying
Sample identification:	alphanumeric, 20 characters
Reset protection:	by locking the keypad
Weighing-in aid (target weight):	0.1–61 g in 0.1 g steps
Limit values weighing-in aid:	1–25% (1% steps)

¹⁾ Data for standard sample pan (diameter 90 mm), with the reusable sample pan the maximum sample weight is 30 g.

²⁾ Instrument acclimatized in room and connected to power supply for 30 minutes, drying temperature 160 °C.

Evaluation

Display modes:	5 modes (moisture, dry content, weight, ATRO moisture content, ATRO dry content = MC, DC, g, AM, AD)
Records:	via built-in printer (Option)

Hardware

Audio signal:	adjustable (soft, loud, off)
Data interface:	LocalCAN universal interface built in, RS232C option
Inspection window:	in heating module
Leveling:	3 leveling screws and level indicator
Display:	LCD, supertwist LCD with backlighting
Status display (User guide):	integrated in display
Alphanumeric entry key:	integrated in keypad
Sample pan, \varnothing :	90 mm
Thermal overload protection:	bimetallic-element switch in heating module
Dimensions (w x h x d):	36 x 11 x 34 cm
Weight, ready to measure:	7.7 kg (with built-in printer)

Admissible ambient conditions

	Use only in closed rooms
Height up to:	4000 m
Temperature range:	5 °C to 40 °C
Atmospheric humidity:	80% RH @ to 30 °C
Voltage fluctuations:	-15%+10%
Installation category:	II
Pollution degree:	2
Power load:	Max. 450 W during drying process
Current consumption:	4 A or 2 A, according to the heating module
Power supply voltage:	100 V – 120 V or 200 V – 240 V, 50/60 Hz (the voltage is given by the heating module)
Power line fuse:	2 (in each conductor), 5 x 20 mm, T6,3H 250 V

Dimensions

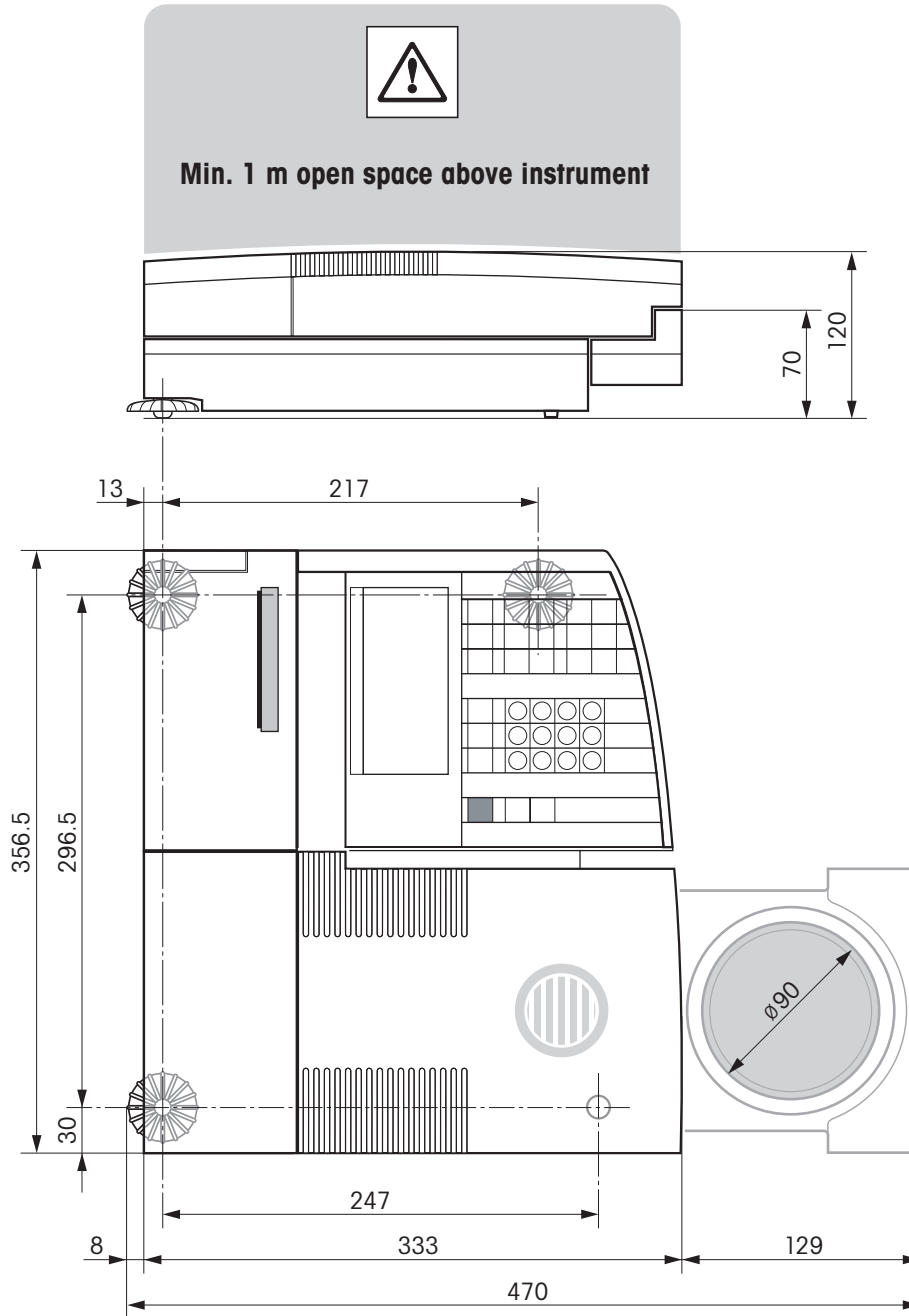

9.7 MT-SICS Interface commands and functions

Many of the instruments and scales used have to be capable of integration in a complex computer or data acquisition system.

To enable you to integrate instruments in your system in a simple manner and utilize their capabilities to the full, most instrument functions are also available as appropriate commands via the data interface.

All new METTLER TOLEDO instruments launched on the market support the standardized command set "METTLER TOLEDO Standard Interface Command Set" (MT-SICS). The commands available depend on the functionality of the instrument.

Basic information on data interchange with the instrument

The instrument receives commands from the system and acknowledges the command with an appropriate response.

Command formats

Commands sent to the instrument comprise one or more characters of the ASCII character set. Here, the following must be noted:

- Enter commands only in uppercase.
- The possible parameters of the command must be separated from one another and from the command name by a space (ASCII 32 dec., in this description represented as $_$).
- The possible input for "text" is a sequence of characters of the 8-bit ASCII character set from 32 dec to 255 dec.
- Each command must be closed by $C_{R}L_{F}$ (ASCII 13 dec., 10 dec.).

The characters $C_{R}L_{F}$, which can be inputted using the Enter or Return key of most entry keypads, are not listed in this description, but it is essential they be included for communication with the instrument.

Example

S – Send stable weight value

Command	S	Send the current stable net weight value.
Response	S$_$S$_$WeightValue$_$Unit	Current stable weight value in unit actually set under unit 1.
	S$_$I	Command not executable (balance is currently executing another command, e.g. taring, or timeout as stability was not reached).
	S$_$+	Balance in overload range.
	S$_$-	Balance in underload range.

Example

Command	S	Send a stable weight value.
Response	S$_$S$_$50.000$_$g	The current, stable weight value is 50.000 g.

The MT-SICS commands listed below is a selected list of available commands. Commands and further information please refer to the Reference Manual "MT-SICS for Halogen Moisture Analyzers HR83/HG63 11780559" downloadable from the Internet under www.mt.com/moisture.

Commands and responses MT-SICS level 0

IO	Inquiry of all implemented MT-SICS commands
I1	Inquiry of MT-SICS level and MT-SICS versions
I2	Inquiry of instrument data
I3	Inquiry of SW version and type definition number
I4	Inquiry of serial number
S	Send stable weight value
SI	Send weight value immediately
SIR	Send weight value immediately and repeat
Z	Zero
ZI	Zero immediately
@	Reset

Commands and responses MT-SICS level 1

D	Display
DW	Weight display (Display show Weight)

Commands and responses MT-SICS level 2

DAT	Date
PWR	Power on/off
P100	Print out text on the strip printer
TIM	Time

Commands and responses MT-SICS level 3

Control commands

HA01	Reset application / escape
HA02	Set factory settings
HA03	Switch keypad on/off
HA04	Open / close automatic sample chamber
HA05	Start / end drying
HA06	Trigger audio signal
HA07	Report instrument status change
HA08	Request printer record

Status inquiries

HA20	Inquiry of instrument status
HA21	Inquiry of automatic sample chamber position
HA22	Inquiry of last balance adjustment
HA221	Inquiry of last balance adjustment test
HA23	Inquiry of last heating module adjustment
HA231	Inquiry of last heating module adjustment test
HA24	Inquiry of temperature
HA25	Inquiry of drying weights
HA26	Inquiry of drying data
HA27	Inquiry of drying result
HA28	Inquiry of drying result with free factor

Instrument settings

HA40	Inquiry / setting of language
HA401	Inquiry / setting of start mode (operating mode)
HA402	Inquiry / setting of key protection (reset protection)
HA403	Inquiry / setting of printer on/off
HA411	Menu parameter: Setting of vibration adapter
HA412	Menu parameter: Setting of acoustic signal
HA413	Menu parameter: Symbols displayed
HA420	Menu parameter: Activate / deactivate methods option
HA60	Select method
HA61	Inquiry / setting of method parameters (part 1)
HA62	Inquiry / setting of method parameters (part 2)
HA621	Definition of comment line

Methods menu

HA631	Activate / deactivate free switch-off criterion
HA632	Activate / deactivate of freely selectable switch-off criterion
HA633	Activate / deactivate free %MC factor
HA634	Definition fo free %MC factor
HA635	Activate / deactivate free g factor
HA636	Definition of free g factor
HA639	Setting of sign for free %MC factor set
HA646	Activate / deactivate drying temperature up to 200 °C without time limitation

Weighing-in aid

HA650	Weighing-in aid no / passive / active
HA651	Weighing-in aid: definition of tolerance range

Method results

HA90	Report keys
HA91	Alphanumeric entry
HA92	Integer entry (positive values only)
HA93	Real entry (positive values only)
HA94	Date entry
HA95	Time entry

9.8 Optional equipment, expendable material and spare parts

Designation	Order No.	Notes
Optional equipment		
Adjustment weight 50 g (Class F1)	15865	Adjustment of balance
Temperature adjustment set, HA-TC	214455	Adjustment of heating module
Calibrated temperature adjustment set, HA-TCC (including test certificate at 50 °C, 100 °C and 160 °C)	214528	Adjustment of heating module
Recalibration from HA-TCC, HA-TCCRe (including test certificate at 50 °C, 100 °C and 160 °C)	214534	Recalibration with certificate
Interface cable LC-RS25 (RS232/25-pin)	229050	
Interface cable LC-RS9 (RS232/9-pin)	229065	
Built-in printer, HA-P43	214456	
Reusable sample pan (steel, height: 6 mm), HA-DR1	214462	Set of 3 piece
Reusable sample pan (steel, height: 15 mm)	13954	1 piece
Transport case, HA-CASE	214515	
Sample pan handler, HA-PH	214526	3 piece
Chemically resistant protective cover, HA-COVER	214533	2 piece
Textile sample pan for bulky samples, HA-CAGE	214695	1 piece
Expendable material		
Printer paper for HA-P43	72456	Set of 5 rolls
Paper roll (self-adhesive) for HA-P43	11600388	Set of 3 rolls
Ribbon (cassette, black) for printer HA-P43	65975	Set of 2 piece
Aluminum sample pan ø 90 mm, HA-D90	13865	Set of 80 piece
Reinforced aluminum sample pan ø 90 mm	11113863	Set of 80 piece
Glass fiber filter (for liquids), HA-F1	214464	Set of 100 piece
Spare parts		
Heating module 110 V HA-HM110	214737	
Heating module 230 V HA-HM230	214738	

If you require other spare parts for your Moisture Analyzer, please contact your METTLER TOLEDO dealer.

10 Index

Symbole

%DC display mode 47

%MC display mode 47

0...9 25, 35

A

Accept entry 17, 25, 44, 50

Accuracy 75

Adjusting the balance 51

Adjusting the heating module 53

Adjustment 23

Adjustment of the balance 51

Adjustment of the heating module 53

Adjustment record 52, 55

Adjustment weight 51, 83

Air bubble 12

Application brochure 76

Application error 69

ATRO dry content 31

ATRO moisture content 31

Audio signal 59, 69

B

Balance adjustment 50, 51

Balance test 53

Basic settings 50

Built-in battery 13

Built-in printer 15, 61, 66, 68, 72, 83

Burning 8

C

Change by locking the appropriate keys 60

Check the heating module adjustment 55

Checking balance adjustment 52

Cleaning 64

Code 35

Comment 35

Comment line 6

Comment lines 35

Computer 75

Control system 75

Corrosion 8

D

Date 16, 58

Delete 35

Dialog language 62

Display 72

Display mode 30, 40

Disposal 9

Draft shield element 14, 64

Dry content 30, 31

Drying and measurement 20

Drying program 26

Drying temperature 22, 23, 26, 40

Drying temperature to 200 °C 48

Drying time 22, 23, 29, 40, 72

E

Equipment 11

Error messages 69, 70, 73

Expendable material 83

Explosion 8

Extension cable 13

F

Factory settings 57

Fire 8

Free factor (-MC) 47

Free factor (g) 48

Free space 14, 18

Free switch-off criterion 29, 76

Freely selectable switch-off criterion 46

Function keys 25

Function symbols 60, 72

G

Glass fiber filter 18, 24, 83

GLP 7, 23

GMP 7, 23

H

Halogen heating module 6

Halogen Moisture Analyzer 6

Heat accumulation 8

Heating module 6, 8, 13, 20, 22, 23, 40, 53, 64, 68, 73, 79, 83

Heating module adjustment 50, 56, 71

Heating module test 56

Heating module test record 56

I

Initial status 18

Input errors 69

Inspection window 54

Instrument safety 7

Interface 75

Interface cable LC-RS25 83

Interface cable LC-RS9 83

Interface commands 75, 81, 82

ISO 14001 7

ISO 9001 7, 23

L

Language 16, 62

Level 12

Level indicator 12

Leveling 12

Leveling screws 12

Line voltage 13, 72

LocalCAN universal interface 7, 75

Location 12, 70, 72

M

Manual printout 32
Manual switch-off criterion 29
Measurement 11, 18, 38
Measurement parameters 22
Measurement record 37
Menu 17, 46, 50, 63
Menu overview HG63 63
Method 44, 46, 49
Method memory 57
Method menu 46
Method menu overview 46
Method number 44
Method option 61
Methods 26, 43
Moisture 6
Moisture content 20, 30, 31
MT-SICS 81

N

Numeric entries 25

O

On/Off 13, 16, 18, 71
Open/close auto sample chamber 14, 18, 38, 59
Operating mode 59
Operating principles 25
Optional equipment 83
Overheating 8, 73

P

Package 11
Paper feed 16, 66
Paper roll 16, 66, 83
Parameter 22, 45
Personnel qualification 6
Poisoning 8
Power cable 13, 72
Power line fuses 66, 72
Power supply 12, 13

Print 32, 40, 50, 52, 53, 55, 56, 69

Print interval 32, 73

Printer 15, 72, 83

Printer paper 66, 83

Printer test 68, 72

Printing out methods parameters 49

Protective cover 83

Protective glass 8, 66

Protective glass of the heating module 68

Q

Quality assurance system 23

R

Rapid drying 26

Ready for start 19

Ready for taring 18

Ready for weighing 19

Record 35, 37, 42, 49, 52, 53, 56

Reference Manual 75

Repeatability 75

Reset 17, 21, 41, 50, 69, 71

Ribbon 15, 66, 83

Ribbon cassette 15

S

Safety 7

Sample 18

Sample chamber 7, 37, 59, 73

Sample pan 19, 24, 51, 83

Sample pan handler 19, 83

Sample pan holder 14, 64, 72

Sample preparation 24

Sample weight 75

Sample weight limits 34

Sample weight tolerance 34

Scroll down 17, 25, 44, 50

Scroll up 17, 25, 44, 50

Self-test 16

Servicing 64

Setting up 12

Settings change 60

Signal 20, 40, 69

Spare parts 83

Special character 35

Specimen sample 18, 19

Stability detector 50, 72

Standard drying 26, 27

Standard equipment 11

Start 20, 39, 54, 56, 59, 73

Status display 7, 18, 38

Stop 38, 41, 42

Switch-off criterion 28, 40, 71, 73

Symbols 60

System errors 69

T

Tare (zero) 19, 39

Target weight (Weighing-in aid) 33

Technical data 78

Temperature 71

Temperature adjustment set 54, 56, 83

Temperature limitation 27

Temperature sensor 64

TEST 52, 55

Test measurement 22, 23, 29, 42

Test record 53, 56

Testing the heating module 55

Textile sample pan 83

Thermogravimetric principle 6, 22, 23

Time 16, 58

Time limit 27

Timed switch-off 29

Trained personnel 7

Transport arrestment 11, 13

Transport case 83

U

User guide 18, 38

V

Vent over 8

Vibration adapter 58

W

Weighing in 33

Weighing-in aid 33, 73

Weight in grams 30

Weight loss per unit of time 28,
76

**To protect your METTLER TOLEDO product's future:
METTLER TOLEDO service assures you of quality, measuring accuracy
and preservation of value of the METTLER TOLEDO products for
years to come.**

Please send for details of our attractive terms of service.

Thank you.



P11780521

Subject to technical changes and to the availability
of the accessories supplied with the instruments.

© Mettler-Toledo AG 2006 11780521A Printed in Switzerland 0607/2.12

Mettler-Toledo AG, Laboratory & Weighing Technologies, CH-8606 Greifensee, Switzerland
Phone +41-44-944 22 11, Fax +41-44-944 30 60, Internet: <http://www.mt.com>